

Reference
Desk

THE
1964-65
Student Council
Handbook



EDDIE FOWLER
Editor

SUSAN MAYER
Illustrator

Southwestern at Memphis

THE
1964-65
Student Council
Handbook



EDDIE FOWLER
Editor

SUSAN MAYER
Illustrator

Southwestern at Memphis

COLLEGE CALENDAR

Session of 1964-65

FIRST SEMESTER

- September 8-14.....Orientation and Registration of New Students
September 8, Tuesday, 3:00 P.M.....Faculty Meeting
September 11, Friday.....*Registration of Returning Students
September 14-15, Monday and Tuesday, 2:00 P.M.....Reexaminations
September 15, Tuesday, 8:15 A.M.....*Opening Convocation; Classes Meet
November 10.....Eight-Weeks Grade Reports
November 25, Wednesday, 12:30 P.M.....Thanksgiving Recess Begins
November 30, Monday, 8:00 A.M.....Thanksgiving Recess Ends
December 8-15Preregistration
December 19, Saturday, 12:30 P.M.....Christmas Recess Begins
January 4, Monday, 8:00 A.M.....Christmas Recess Ends
January 21-28Examinations

SECOND SEMESTER

- February 2, Tuesday.....*Registration
February 3, Wednesday.....Classes Begin
March 8-9, Monday and Tuesday.....Reexaminations
March 31.....Eight-weeks Grade Reports
April 15, 12:30 P.M.....Easter Recess Begins
April 21, Wednesday, 8:00 A.M.....Easter Recess Ends
April 27-30Preregistration
May 20-27Examinations
May 30, Sunday, 11:00 A.M.....**Baccalaureate Service
May 31, Monday, 10:00 A.M.....**Graduation Exercises
Comprehensive Examinations, First Semester, January 16, 18, 20, 1965.
Comprehensive Examinations, Second Semester, May 15, 17, 19, 1965.

*All fees must be paid by 5:00 P.M. this date

**Formal academic occasion.

ODDS AND ENDS

Every incoming freshman has certainly heard various tales of his new alma mater, some fact, some fantasy. No collection of such items would be complete without the following:

Southwestern, Southwestern, across from the zoo,
Where the girls are girls, and the boys are too.

Freshman girls, do not be alarmed at the rumors you have heard about Southwestern men. You ask the upper-class women, "Is it really true what we hear? Are the Southwestern men really so very passive?" Well girls, let me conclude by saying this, and you judge for yourselves. Do not confuse simple passiveness with wise passiveness. For where there is a will, there is a way. So do what you will young ladies, but beware of the Southwestern male's ways!

SEAL OF SOUTHWESTERN AT MEMPHIS



Circular in form, the red and black seal of Southwestern is centered by a black shield representing faith. Quartering the shield is a St. Andrew's Cross denoting Christianity, and in the middle of the cross lies an open Bible, the heart of Southwestern's being. Each of the shield's four divisions bears a symbol representing a period in the college's history—as a Masonic College at Clarksville, founded in 1848, as "Stewart College" (1855-75); as "Southwestern Presbyterian University" (1875-1925); and finally as "Southwestern at Memphis" when it was moved to Memphis.

The intertwined sprigs of oak and laurel under the shield signify strength and victory. Surrounding the shield on the other three sides are the words "Truth, Loyalty, Service"—the fundamental precepts of Southwestern.

TABLE OF CONTENTS

College Calendar	3
Odds and Ends	4
Seal of Southwestern	5
Southwestern Fight Song	8
Southwestern Alma Mater	9
A Message from the Student Council	10
A Greeting from President Rhodes	11
Through the Years	12
General Information	14
Academic	14
Residence Halls	14
Health	15
Parking of Cars	15
Bookstore	15
Dining Hall	15
Lost and Found	16
Student Aid	16
Lynx Lair	16
Chapel	16
Tutoring	16
College Regulations	17
Class Attendance	18
Library Regulations	19
Student-Faculty Committees	20
Spirit of Honor	21
Honor Council	23
Student Government	26
Student Council Officers	27
Constitution of the Student Body	28
Point System	37
Class Officers	38
National Student Organization Committee	39
Elections Commission	39
Women's Undergraduate Board	39

TABLE OF CONTENTS (continued)

Map of Southwestern	32 & 33
Campus Events	40
Campus Social Affairs	42
Social Regulations	42
Use of Fraternity and Sorority Houses	44
Use of the Gymnasium	45
Educational Activities	46
Athletics	47
College Athletic Conference	48
Publications	49
Religious Activities	51
Organizations	53
Honorary	53
Departmental	55
Greek Letter Organizations	56
Sororities	56
Women's Panhellenic Council	56
Independent Women	58
Intersororities	58
Fraternities	59
Intrafraternity Council	59
Independent Men	60
Fraternity Rushing Rules	61

SOUTHWESTERN FIGHT SONG

— ON THE PROWL —

Southwestern will win the vict'ry again;
The Lynx cats are on the prowl.
We follow the law of the fang and the claw,
And the Red and Black will leave their track
All over the foe, wherever we go.
Tonight's our night to howl!
We're leavin' our lair, you'd better beware
For the Lynx cats are on the prowl!

R. L. "Bob" Frank

Class of '66

SOUTHWESTERN'S ALMA MATER

JOHN BOWEN EDWARDS

ISAAC PIERCE MASON

Re-harmonized by Ernest F. Hawke

Dear Al - ma Ma - ter, kind the fate That links our lives with Thee.
Thy stal - wart towers of sol - id stone, Thy vault - ed arch - es strong,
O Lead - er to the larg - er light, South - west - ern, 'neath Thy wings

For God's own power that made Thee great Is the truth that makes us free;
In - spire our loy - al hearts each one To fight a - gainst the wrong;
Thy sons in rev - erent love u - nite, And each his trib - ute brings:

Thy torch has touched our hearts with flame, Our yearn - ing souls re - fined;
Our lives re - flect the beau - ty of Thy state - ly clos - ter'd halls,
And dreams such dreams as old men dream, And vis - ions young men see,

Through Thee we learn the high - er aim, And train the tru - er mind,
And char - ac - ters grow gen - u - ine That dwell with - in Thy walls,
Keep light - ed in our hearts the flame Once kin - dled there of Thee.

A MESSAGE FROM THE STUDENT COUNCIL

It is with the greatest cordiality that I extend, in behalf of the student body of Southwestern, a welcome to the class of 1968. And in the same tone I should like to commend the Student Council Handbook to your use as the first and most complete means available for guiding you through the complexities of your first experiences with college life at Southwestern.

The new student is often confused by the enormous amount of information he is expected to digest concerning various student and college organizations, campus regulations and Southwestern's rich heritage of traditions. Only in the Student Council Handbook can all of this information be located at a glance. The Student Council would like to commend Eddie Fowler for the fine job he has done in editing this year's Student Council Handbook. It will be to your advantage to read carefully over this handbook even before you arrive at Southwestern. In order to make sure everyone is familiar with the college, its tradition, regulation, and organizations, a test covering the material in the handbook is administered to all new students during Orientation Week.

The heritage, aspirations, and opportunity for a liberal education which are a part of Southwestern are about to pass into your hands. I trust you will, beginning with the material in the Student Council Handbook, come to know and make full use of all the aspects, past and present, which have made Southwestern one of the finest liberal arts institutions in the South.

Cordially yours,
Harvey Caughey
Student Body President

A GREETING FROM PRESIDENT RHODES

I appreciate this opportunity to include in the Student Council Handbook a word of greeting to the Class of 1968.

The word **alumnus** means **one who is nourished**, and as soon as you enroll in Southwestern you become an **alumnus**, or one **nourished** by the traditions of the past, the activities of the present, and the aspirations for the future of the college which you have chosen, and which has chosen you.

You certainly cannot **get** an education at Southwestern as you would get a tankful of gasoline at a filling station, but if you are diligent in your classes and discriminating in your extra-class campus participations you can build a capacity to determine those values which **matter** to a liberally educated individual in a Christian context.

If you are wise you will learn from a variety of experiences and encounters to tell the best from the good, the excellent from the shoddy, the essential from the incidental, expanded horizons from cramped prejudices, mature and responsible action from ill-considered and transient enthusiasms.

I welcome you as a fellow student committed to seeking here the good life of mind and spirit.

Sincerely yours,
Peyton N. Rhodes
Peyton N. Rhodes

GENERAL INFORMATION

Academic

The Dean of the College, Jameson M. Jones, is directly responsible to the president in all matters pertaining to the faculty and student body. He advises with students about their courses of study and about the welfare of the community life of the college. The Dean's office is on the second level of the Halliburton Tower Building.

The Dean of Women, Miss Anne S. Caldwell, is available to women students for consultation; all girls are invited to visit her office, which is located in the Tower Building. One of Dean Caldwell's most helpful jobs is aiding women students in finding interesting summer employment.

The Dean of Men, Charles I. Diehl, also has an office in the Tower Building, and invites new students to come in and discuss courses of study.

Dr. Ray Allen, Dean of Admissions and Records, heads the admissions offices which occupy three rooms on the first floor of Palmer Hall. John C. Turpin, the associate registrar, is available to help with schedule problems, and Mrs. John Q. Wolf is admissions counselor.

Residence Halls

The women's residence halls, Townsend, Voorhies, and East Halls are under the jurisdiction of student governing boards. A copy of the residence hall's rules is mailed to all new women students who plan to live in the residence halls.

The resident head of Voorhies is Mrs. A. H. Cable. Mrs. Paul M. Watson is the resident head of Townsend and East Halls. Miss Lou Banks Fulton is the assistant resident head of Townsend Hall, and Miss Mary Porter and Miss Jeanne Wertz are the assistant resident heads of East Hall. Miss Frances Phillips is assistant resident head of Voorhies Hall. Dorm presidents are Miss Jeanne Heltzel, Voorhies Hall, and Miss Beth Daniel, East Hall. Miss Kay Willis is executive president of all three halls.

The five men's residence halls are governed by a president in each hall, elected by the students. These presidents are: Cam Murchison and Jim Fall, Bellingrath Hall; Bill Hunt, Ellett Hall; Lester Goodin, Robb Hall; Stan McNeese and Dan Daniel, Stewart Hall; and Tommy Durff, White Hall.

Health

The newly completed Moore infirmary is maintained for the treatment of ordinary student illnesses. Dr. J. L. Hobson is the college physician, and Mrs. Allie Haener, a registered nurse, is on duty at all times. Students requiring the services of the physician should report to the infirmary at 8:30 A.M. on week days.

Clinic hours:

Monday to Friday.....8:00 A.M. to 3:00 P.M.

Saturday.....8:00 A.M. to 12:00 noon

All routine treatments are to be given during these hours. Emergencies are, of course, taken care of at any time.

The college provides, at no cost to the student, accident, sickness, and hospitalization insurance. Students requiring special services must be referred by the college physician in order for the insurance to be effective.

Parking of Cars

Parking areas have been provided by the college north of the Science Building and Palmer Hall, as well as east of Burrow Library and south of Bellingrath Hall. Random parking of cars on the college grounds is prohibited at all times. Penalty for parking in other than designated places, \$2.00 Fine.

Book Store

The Book Store is located on the ground floor of Neely Hall. All books assigned by professors may be obtained there. The hours are:

Monday-Friday8:00 to 4:00

Saturday8:00 to 12:00

Dining Hall

Dining hours are as follows:

Breakfast:

Monday-Saturday7:30-8:30

Sunday8:00-8:30

Lunch:

Monday-Saturday11:30-1:15

Sunday12:00-1:15

Dinner:

Monday-Saturday	5:00-6:00
Sunday	5:30-6:00

All men must wear coats and ties throughout the evening and Sunday noon meals.

If Bermuda shorts are worn at the evening meal, knee-length socks must be worn as well as a coat and tie. Sport shirts must have collars; "T" shirts will not be permitted at any time in the dining halls.

Lost and Found

Lost and found articles are handled through the cashier's office in room 103 of Palmer Hall.

Student Aid

Students needing aid should see Dean Ray Allen. Part-time campus employment is available for a limited number of students.

Lynx Lair

The Lynx Lair, located on the ground level of Neely Hall, is operated by Mr. Bob Poole solely for the convenience of the students at no profit to the college. There are bridge tables, a juke box, and a snack counter for the students' enjoyment. The Lair is closed on Sunday.

Chapel

College convocations for all faculty and students are held Monday and Tuesday in Hardie Auditorium in the east end of the second floor in Palmer Hall. On Wednesday student assembly is held in the gym, and Thursday chapel is in Evergreen. More specific information is to be found concerning chapel convocations under college regulations in this handbook.

Tutoring

Tutoring services are handled through the Dean of Women's office. Anyone wishing a tutor should notify this office.

COLLEGE REGULATIONS

Rules are kept to a minimum at Southwestern. The following are traditional properties and customs.

Conduct befitting a lady or gentleman is expected of all Southwestern students. Rowdiness, drunkenness, and other improper conduct will result in the expulsion from the college of all persons involved. No intoxicants are to be served at any dance, party, or other function given by any college organization or brought into any building or kept anywhere (including in automobiles) on the campus. Students are not allowed to have guns on the campus or keep animals in their rooms.

1. No smoking is permitted in the halls, cloister, classrooms, laboratories, or dining halls.

2. There will be no card playing in the social room of Palmer Hall.

3. A college convocation is held in Hardie Auditorium at 10:00 every Monday and Tuesday, in the gym on Wednesday and Thursday in Evergreen. These convocations are for worship, lectures, concerts, and other programs of educational value. Because Hardie Auditorium cannot accommodate the entire student body, the group is divided in half and students are required to attend the meetings either on Mondays or Tuesdays and Wednesdays and Thursdays. Schedules for attendance records will be set up in the fall in the hall outside Hardie.

On Wednesday Student Assemblies are held in Mallory Gymnasium.

4. Boarding students may keep cars on the campus only by strict adherence to the rules set forth in the catalogue.

5. Shorts and slacks are not to be worn on the campus by women students, except when participating in athletics or decorating.

6. Cars shall be parked on the college grounds only in those parking areas provided by the college.

7. In order to change a course, a student must have the permission of the instructor and the dean. If any irregularity is involved in the course change, a student must

present a petition, with his faculty advisor's signature on it, to the Classification Committee. More information may be obtained in the catalogue.

8. In order to graduate, a student must have completed 120 semester hours of work, with 120 quality points. Quality points are given by grades as well as hours. An "A" counts three quality points per hour, a "B" two, a "C" one, and a "D" or "F" counts none. Therefore, an "A" in a three hour course is nine quality points; in a four hour course, it is twelve points.

9. The grade point system of averages counts "A" as four points, "B" as three, "C" as two, "D" as one, and "F" as none.

Class Attendance

Regular attendance is essential for success in academic work and is required of all students. Each instructor will take attendance rolls daily. Students should present to their instructors a written explanation of absences they consider necessary. When and if a student's absence from class seems to the instructor to jeopardize the student's work in the course or is so persistent as to justify a formal inquiry, the instructor will call the matter to the attention of the Dean of Men or the Dean of Women who will, when necessary, bring in the student's advisor in investigating and judging the situation. Notice will then be sent to the student, the parents, and the instructor as a warning that further absences may lead to suspension from and failure in the course. If and when a student's absences seem to the instructor to make the student unfit to continue in the course, the instructor will make a written recommendation to the Dean of Men or to the Dean of Women that the student be dropped from the course. On recommendation from a committee composed of the Dean, the Dean of Men and the Dean of Women, the Registrar will drop the student from the course. If a student is recommended for exclusion from as many as two classes, his parents will be urged to withdraw him from college; if he is recommended for exclusion from as many as three classes, he will be required to withdraw from college.

The above provisions apply to all students. The following and additional regulations apply to freshmen only. The

faculty will report to the Registrar all freshmen absences not later than the Monday after the absences occur. Freshmen seeking excuse for absence must present a written request to the Dean of Men or the Dean of Women within one week after their return to classes. Absences on the two days before and after holidays count double.

In case of excessive absences, academic credits will be added to the number required for graduation on the basis of one-third credit for each unexcused absence in excess of the unpenalized number of absences, which number is the same as the number of semester hours represented by the course. If the fractional deductions exceed one half-hour, they will be counted as a full hour.

In the case of students absent when representing the college officially, the responsible official will report their absences to the Dean of Men or the Dean of Women for excuse.

LIBRARY REGULATIONS

Hours: Monday through Friday, 8:00 A.M.-10:00 P.M.

Saturday, 8:00 A.M.-5:00 P.M.

The library staff extends a warm welcome to you to use the materials and services of the Burrow Library in the happiest possible manner. To help you get the most from these, your librarians are always ready to be of assistance.

Location of Books

It is your privilege to locate any book in the library's holdings by looking it up under author, subject, or title, in the alphabetically arranged card catalogue. A modern catalogue for phono-records enables you to locate listening materials. In the reference room many volumes will lead you to articles and facts on every conceivable subject. The latest issues of periodicals are in the periodical room, while back issues are available at the center desk, if unbound, and in the main stack area if bound.

"Open shelf" is the rule on the books in the stacks which are distributed on the various floors as shown on cards at the doorways to the stacks and elsewhere. If the book you wish is out, you may leave a request for it at the desk. When it is returned you will be notified how long it can be held for you.

Student Library Committee

The Student Library Committee, a subcommittee of the Student Council, forms a link between the students and the library staff. The committee is composed of a chairman and five members from the Student Body. The chairman shall be appointed by the Student Council; one committee member shall be a representative from the Honor Council and shall be appointed by that body; and the other four members shall be appointed by the new chairman and the entire retiring committee with the approval of the Student Council. The committee receives reports of and advises on campus feeling concerning the library and cooperates on special programs and exhibits.

STUDENT-FACULTY COMMITTEES

Hall of Fame Committee

The Hall of Fame Committee chooses a minimum of three and a maximum of seven seniors to Southwestern's Hall of Fame which is announced in the Yearbook. Pictures of each year's choices are hung in Palmer Hall. The committee consists of:

Dick Johnston.....	Junior Class President
Tommy Brooks.....	Junior Vice-President
Ray Bye, Carolyn Crane, Walter Howell	
.....	Junior Representatives
George Abraham.....	Sophomore Class President
Mr. Charles I. Diehl.....	Dean of Men
Miss Anne S. Caldwell.....	Dean of Women

Who's Who in American Colleges and Universities

The Student Council nominates ten to thirteen seniors for this national honor. A faculty committee makes the final selections from these nominees.

Student Welfare Committee

The Student Welfare Committee, with Professor Fred Neal as chairman, is composed of selected faculty members and the Student Council president, vice-president, secretary, and social commissioner. The committee passes on the social calendar and all parties, and takes over action and policies regarding the welfare of students.

SPIRIT OF HONOR

Southwestern is noted for the spirit of honor on its campus. Though the Honor System was enacted by the students many years ago, it has not become a meaningless institution, but has grown greatly in stature. The Honor System presently is just as much a part of Southwestern as the academic curriculum itself. Under the System students assume responsibility for honorable conduct not only in tests and examinations, but also in other phases of college life. The student is put entirely on his honor to be honest in all of his undertakings.

The spirit of honor should manifest itself in every phase of life at Southwestern.

The Honor System is administered by an Honor Council which is composed entirely of students elected by their fellow students. This Honor Council operates without interference from the college administration. The Council acts as a court to try any violations of the Honor System, and disciplines any student found guilty of such violations.

Only an intelligent group of people can understand and maintain the real meaning of such a delicate system. Every student pledges himself to uphold this Honor System on entering Southwestern. Neither the student nor the Honor Council is pledged to police other students. Everyone is to be concerned with his own work and proper behavior. If a student observes the breaking of the spirit of honor and pledge in a noticeable way on the part of another student, then he is obligated to bring the facts to the council for investigation. No one is expected to be overly suspicious; but overprotection of a dishonest student cannot be tolerated.

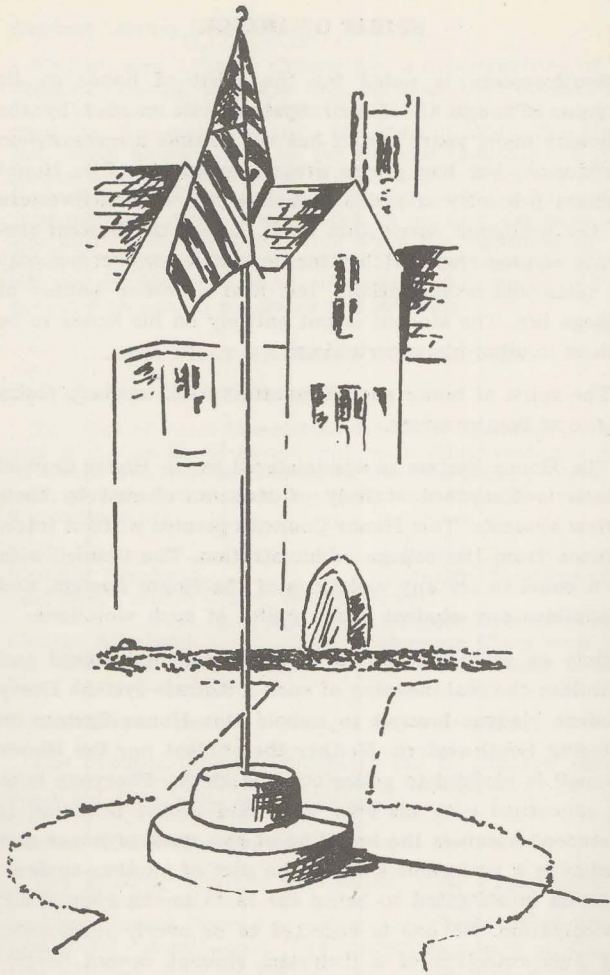

THE HONOR COUNCIL

Article I. Name and Purpose

Section 1. The name of this body shall be the Honor Council of Southwestern at Memphis.

Section 2. The purpose of this council shall be to foster a spirit of honor at Southwestern; and to investigate and to act upon cases of cheating, stealing, and lying (in official matters) on the part of students in connection with academic work or campus life.

By-Laws, Article II. Oaths and Pledges

Section 1. Each student who enters Southwestern shall sign and adhere to the following pledge:

As a student at Southwestern, I hereby pledge my full and hearty support to the Honor System. I pledge to be honest myself, and, in order that the spirit and integrity of the Honor System may endure, I pledge that I will make known to the Honor Council any case of dishonesty which I may observe at Southwestern.

Article IV. Instruction

Section 1. To insure the cooperation of the faculty in the support of the Honor System, the council shall, at the first of each semester, discuss the system with the faculty, reminding them of their obligations to report violations, asking them to request the full written pledge on their work, asking them to remind students before each test that the test is to be pledged, and to clarify in the minds of their students which work is to be pledged and which work is not to be pledged.

Section 2. To insure the full understanding and support of the Honor System by the student body, the council shall, each summer, send letters of instruction to incoming stu-

dents; explain the system during freshman orientation; request that fraternities and sororities include the Honor System in their pledge training; conduct a special chapel program before semester examinations; see that each student has a copy of the Honor Council Constitution; place printed cards outlining the system in each classroom . . . and empower the president of the Honor Council to meet with the Student Council from time to time to discuss the system.

THE 1964-65 HONOR COUNCIL

Tommy DurffPresident

Bob WildVice-President

Representatives:

Senior Class.....Billy Hunt
 Judy Moody
 Cam Murchison
 Judy Wood

Junior Class.....Carole Pickens
 Stan McNeese
 Judy Simono
 Bob Wild

Sophomore Class.....Bob Glasgow
 Chris Reveley
 Pam Richardson
 Mike Whitaker

Freshman Class.....To be elected in
 the Fall

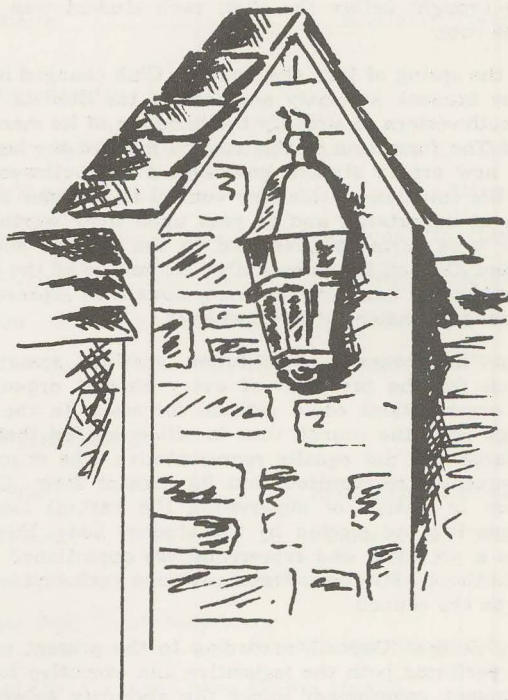

STUDENT GOVERNMENT

During Southwestern's early years in Memphis, student body affairs were handled by the Boosters Club, a democratic organization whose membership consisted of the entire student body. All matters concerning the student body were brought before the club; each student was entitled to one vote.

In the spring of 1927, the Boosters Club changed its name to the Student Assembly and formed the Student Council of Southwestern to simplify the handling of its many questions. The formation of this council marked the beginning of a new era in student government at Southwestern. It was the function of this new council to consider all questions of importance and to pass upon their worth before these were formally presented to the student body. The Student Council is the executive committee of the Student Assembly and has become synonymous with representative student government at Southwestern.

The first council's constitution provided seats on the council for the president of every student organization; new organizations could petition for seats. In the 1947-48 college year, the council then in office decided that it was too large and not equally representative. The council was subsequently reorganized into its present form. Commissioners in charge of supervising the various aspects of campus life are elected by the student body. Each class elects a president and representatives apportioned according to the constitution. These positions each represent one vote on the council.

The Student Council, according to the present constitution, performs both the legislative and executive functions of student government under the authority delegated by the college administration. The adequacy of the Council's operation under such a setup has been subject to much debate and separation of the executive and legislative functions, as well as other substantial reforms, is being contemplated.

1964-65 STUDENT COUNCIL OFFICERS

Harvey CaugheyPresident
Dan DanielVice-President
Susan SmithSecretary-Treasurer

COMMISSIONERS

Vern McCartyAthletics
Stan McNeeseEducation
Dale SeayPublications and Publicity
Cam MurchisonReligious Activities
Bill AllenSocial Activities
Larrie Del DanielUndergraduate Women

OTHER MEMBERS

Smitty SmithSenior Class President
Dick JohnstonJunior Class President
George AbrahamSophomore Class President
Didi Hale, Billy Hunt, Judy Wood
.....Senior Class Representatives
Raymond Bye, Carolyn Crane, Walter Howell
.....Junior Class Representatives
Mimi Anderson, Don Hollingsworth, Bo Scarborough
.....Sophomore Class Representatives
Freshman Class RepresentativesTo be elected

CONSTITUTION OF THE STUDENT BODY OF SOUTHWESTERN

Preamble

We, the students of Southwestern at Memphis, in order to provide for student welfare, organization of student activities, and student government under the authority delegated by the college administration, do hereby establish this constitution of the Student Body of Southwestern.

Article I. Name

Section 1. The name of this organization shall be "The Student Body of Southwestern."

Article II. Membership

Section 1. Every regularly enrolled student in this college shall be a member of the Student Body of Southwestern.

Article III. Officers

Section 1. The officers of the Student Body shall be the president, vice-president, and secretary-treasurer.

Section 2. The duties of the president shall be to preside over all meetings of the Student Body; to act as president of the Student Council and preside over all its meetings; to be a member ex-officio of all committees of the Student Body; to be the official representative of the Student Body in matters affecting the interests of the students.

Section 3. The duty of the vice-president shall be to function as the president in his absence, serve as president of the elections commission, chair the Sanhedrin, and preside at the nominations convention.

Section 4. The secretary-treasurer shall: keep a permanent record of the proceedings of the Student Body and of the Student Council; be responsible for all correspondence of the Student Council; be responsible for administering all financial business of the Student Council; and in the absence of both the president and the vice-president preside over all meetings of the Student Body and the Student Council.

Section 5. The officers of the Student Council shall be rising seniors in their second semester of college residence.

Section 6. The officers of the Student Body shall be ex-officio members of the Student Welfare Committee of the college.

Article IV. Executive Powers

Section 1. The executive powers of the Student Body shall be vested in the president.

Article V. Legislative Power

Section 1. The legislative power of the Student Body shall be vested in the Student Council and shall be exercised by a majority of the whole Council. The Council may by a two-thirds vote of its membership refer any proposed legislation or by-laws to the Student Body.

Section 2. New legislation or by-laws shall be announced in student assembly to take effect three days subsequently, unless within that period a petition signed by fifty members of the Student Body orders a referendum vote by the Student Body. In such case the measure shall not take effect unless adopted as provided in Section 3.

Section 3. After the presentation of such a petition a majority vote of the whole Student Body, at a mandatory special or general election to be held within fifteen days, shall be required for the adoption of any referred action or proposal of the Student Council.

Section 4. A petition signed by fifty members of the Student Body shall refer any existent Council action, rule or legislation, or by-laws to the vote of the Student Body at a special or general election within fifteen days. A majority vote of the whole Student Body shall be required to annul such measure.

Section 5. A referendum vote on the same subject shall in no event be repeated within six months.

Section 6. An amendment to the constitution and/or code of the Publications Board, the Protestant Religious Council, the Women's Undergraduate Board, or the Election Commission shall require approval by majority vote of the whole Student Council.

Article VI. Membership of the Student Council

Section 1. Members of the Council shall be the president, the vice-president, and the secretary-treasurer of the Student Body; two representatives from each class, one man and one woman, one of whom shall be president of the class; the commissioner of Athletics; the commissioner of Education; the commissioner of Publications and Publicity; the commissioner of Religious Activities; the commissioner of Social Activities; the commissioner of Undergraduate Women.

Section 2. The officers of the Student Body and the six commissioners shall be elected by the Student Body. The two class representatives shall be elected by their respective classes.

Section 3. A two-thirds vote of the Council shall be necessary to remove a member of the Council and a two-thirds vote of the Student Body shall be necessary to remove the president, the vice-president, or the secretary-treasurer from office.

Section 4. No person shall hold more than one position on the Student Council.

Section 5. The Women's Panhellenic Council and the Inter-Fraternity Council shall each send one representative to the Student Council. These representatives shall be recognized as members of the council, but they shall not be allowed to vote.

Section 6. In order to be eligible as a candidate for office on the Student Council, a person must maintain at least a 2.0 average.

Article VII. Duties of the Student Council

Section 1. The Student Council shall consider and determine all matters generally pertaining to the Student Body.

Section 2. It shall endeavor to express student opinion fairly and accurately.

Section 3. The Student Council shall serve as intermediary body between the students and faculty and administration through the Student Welfare Committee and shall co-operate with the faculty and administration in all matters of common interest and concern.

Section 4. It shall authorize, control, and post audit the disbursement of Student Body funds.

Article VIII. Amendments

Section 1. An amendment to this constitution shall be proposed by a two-thirds vote in two successive regular meetings of the Student Council. It shall be adopted as a part of this constitution by a majority of the whole Student Body.

By-Laws

1. Student elections shall be conducted by the Elections Commission, according to this constitution.

2. The vice-president of the Student Body shall automatically become president of the Elections Commission and be responsible to the Student Council for the conducting of all elections.

3. Candidates for the Student Body offices and six commissioners shall be nominated at two conventions (one composed of representatives of sororities and fraternities; the other composed of seven seniors, six juniors, five sophomores, and four freshmen chosen by the Student Council) in the second week in April. Immediately after this election the class officers, president, vice-president and secretary-treasurer and representatives to the Student Council and Publications Board shall be nominated by petition. Each class will nominate and elect its own officers.

4. All Honor Council elections shall be held in accordance with the constitution of the Honor Council.

5. The commissioner of Publications shall automatically become president of the Publications Board and chairman of the Student Publicity Committee. A candidate for this office must have worked with a Southwestern publication.

The Student Publicity Committee is responsible for campus publicity of the Student Council activities.

6. The commissioner of Religious Activities shall automatically become president of the Southwestern Protestant Religious Council, be ex-officio member of the Chapel and Religious Life Committee. He shall be generally responsible for the religious activities on the campus. A candidate

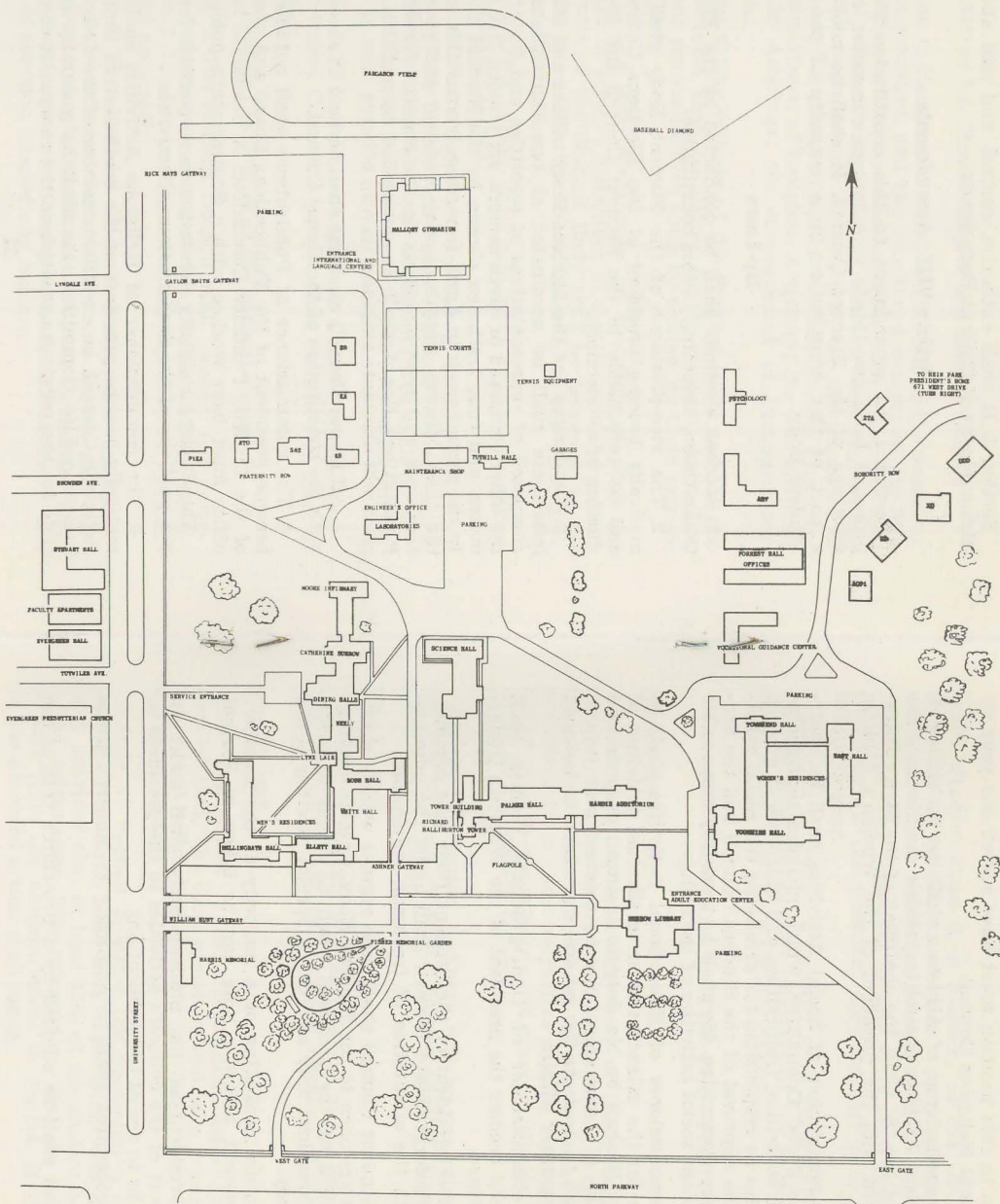

SOUTHWESTERN AT MEMPHIS

for election to this position must have served one year on the Protestant Religious Council.

7. The commissioner of Athletics shall act as chairman of the Student Athletic Committee, which shall include the president of the "S" Club, the chairman of the Men's Intra-mural Board, and the president of the Women's Athletic Association.

8. The commissioner of Social Activities shall be chairman of the Social Committee, which includes representatives of the sororities, fraternities, and independent groups. He shall also be responsible for arranging the social calendar with the approval of the Student Council and the Student Welfare Committee. He shall be generally responsible for the student social activities of the college.

9. The commissioner of Educational Activities shall be responsible for the extracurricular intellectual activities of the college. It shall be his duty to institute projects and other media of communications to interest and inform students and to promote the general discussion on cultural and contemporary affairs.

10. The commissioner of Undergraduate Women shall automatically become the president of the Women's Undergraduate Board.

11. The vice-president of the Student Body and commissioner of Undergraduate Women shall assist the administration with the orientation of freshman regulations.

12. The Student Council shall have regular weekly meetings which are open to the Student Body. Special meetings may be called by the president when he deems it necessary. The president may also call a special meeting of the Student Body.

13. A quorum consisting of a majority of the members must be present before a vote can be taken in Student Council.

14. The president of the Student Body shall make an annual report of the council's activities to the president of the college or to one of the publications.

15. All procedures shall be according to **Robert's Rules of Order**.

16. By-laws shall be adopted by a two-thirds vote of the

entire Student Council. A majority of the whole Student Council shall determine whether a proposed measure shall rank as ordinary legislation or as a by-law.

17. The Vice-President of any class shall take over the presidency if the president does not return to school the following year.

Addition to By-law 6 adopted April 23, 1963—The Student Council shall choose four members of the student body to serve on the Protestant Religious Council.

AMENDMENTS TO THE CONSTITUTION

September 26, 1961

Article VI, Section 1—Members of the council shall be the president, vice-president, and secretary-treasurer of the student body; presidents of the classes and representatives from their respective classes, each class being represented in accordance with class enrollment as established by the student council.

October 17, 1961

Article VI, Section 1—There will be one representative per 100 students or major portion thereof. One must be a boy and one a girl.

May 15, 1962

Article VI, Section 1—The president of the Southwestern Athletic Union will be a voting member of the Student Council.

May 22, 1962

The amendment to the constitution made on May 15 was defeated. The SAU president will be a member of the council, but will not have voting privileges.

March 19, 1963

Article V, Section 3—After the presentation of such a petition, a majority vote in a referendum will decide the issue, provided that at least 50% of the student body votes in the referendum. The referendum shall be held within 15 days from the announcement in chapel. If there is a tie, the proposed action shall stand.

Article V, Section 4—A petition signed by 50 members of the student body shall refer any existent Council action, rule, or legislation, or by-law to the vote of the student body at a special or general election within 15 days. A majority of those students voting shall be necessary to annul such measure, providing that at least a majority of the student body votes in the referendum.

April 9, 1963

Article VI, Section 1—There shall be three representatives from each class and there shall be an additional representative for every one hundred or major fraction thereof in a class over three hundred.

POINT SYSTEM

No student may have more than three activity points at any one time. The number of points based solely on the estimated time normally required for each position are as follows:

Student Governing Positions:

Student Body president	3
Student Body vice-president	3
Student Body secretary-treasurer	3
Commissioners	2
Class President	2
Class representatives to the Student Council.....	1

Honor Council:

President	3
-----------------	---

Resident Hall Governing Boards:

President	1
-----------------	---

Social Fraternal Organizations:

Sorority or fraternity president	3
Sorority or fraternity treasurer	2
Sorority or fraternity pledge trainer	2
Women's Panhellenic Council president	2
Inter-Fraternity Council President	2

Independent Women or Men president	3
--	---

Positions on Student Publications:

Sou'wester editor	3
Sou'wester business manager	3
Sou'wester managing editor	1
Lynx editor	3
Lynx business manager	2
Lynx assistant editor	1

Athletic Organizations:

"S" Club president	1
Cheerleader	1

Denominational Group president	1
--------------------------------------	---

Presidents of honorary organizations	1
--	---

CLASS OFFICERS

SENIOR CLASS

Smitty Smith	President
Carl Fisher	Vice-President
Frances Phillips	Secretary-Treasurer
Lynn Williams	Publications Board Representative
Didi Hale, Billy Hunt, Judy Wood	Student Council Representative

JUNIOR CLASS

Dick Johnston	President
Tommy Brooks	Vice-President
Sammy Ann Primm	Secretary-Treasurer
Sara Means	Publications Board Representative
Ray Bye, Carolyn Crane, Walter Howell	Student Council Representative

SOPHOMORE CLASS

George Abraham	President
Willie Edington	Vice-President
Judy Alexander	Secretary-Treasurer
Susie Danforth	Publications Board Representative
Bo Scarborough, Mimi Anderson, Don Hollingsworth	Student Council Representative

FRESHMAN CLASS

To be elected in the fall.

NATIONAL STUDENT ORGANIZATIONS COMMITTEE

The scope of the National Student Organizations Committee encompasses any regional or national student organization. The Committee's purpose is to transplant the educational interest and awareness generated by these organizations into the Southwestern community. The Committee's primary concern is with the National Student Association, a non-partisan, non-sectarian, non-profit confederation of college student bodies from every part of the country which are associated to give consideration to questions of mutual concern.

Jim Houston	Co-ordinator
Stan McNeese	Student Representative to National Student Congress

ELECTIONS COMMISSION

The Elections Commission is in charge of all student body and class elections. The function of this commission is to insure fair elections, to supervise balloting, and to penalize individuals or organizations detected in unfair practices in any matters pertaining to student elections.

In April, two conventions meet (the Red convention made up of representatives of the sororities and fraternities; the Black convention of appointees of the Student Council) to select candidates for the Student Body officers. Additional candidates may be nominated by petitions submitted to the Elections Commission and subject to the regulations of that group.

The Vice-President of the Student Body is automatically president of the Elections Commission.

Dan Daniel	President
------------------	-----------

WOMEN'S UNDERGRADUATE BOARD

The Women's Undergraduate Board is made up of elected officers of the board; all women members of the Student Council; the secretary-treasurers of all the three classes; the presidents of WAA, Torch, Women's Panhellenic Council, the Dormitory Governing Board, and Independent Women; the co-chairmen of the Student Counselors; and the captain of the cheerleaders.

The purpose of this organization is to cultivate a strong school spirit, bring attention to good scholastic standing, and foster a spirit of honor among all women students. The board assists with freshman orientation. Throughout the year the board as representative of all women students works with the Dean of Women.

Larrie Del Daniel	President
-------------------------	-----------



CAMPUS EVENTS

Homecoming

Homecoming festivities usually fall during the month of October. The student body elects a queen and the "S" Club and football team each select a princess.

Fraternity and sorority lawns are decorated and judged on the basis of originality and appearance.

Annual events include a pep rally, bonfire, football game, fraternity open houses, and the Homecoming dance.

All-Sing

Kappa Delta sponsors an All-Sing each year to raise funds for its philanthropic work. Each Greek letter organization presents two songs, and the fraternity and sorority winners are awarded trophies.

Stunt Night

To further its philanthropic work, Alpha Omicron Pi sponsors Stunt Night. Following presentation of original skits by each sorority and fraternity, trophies are awarded to the winning groups.

April Fool Carnival

On the weekend nearest April 1, Southwestern celebrates April Fool Weekend with its annual carnival. On Friday evening is the performance of a play written, directed, and presented by Southwestern students. Saturday afternoon a concert is often given featuring a top flight entertainment act.

At the costume ball on Saturday evening, the carnival royalty, chosen by the student body, are presented. The king, queen, prince, princess, lords, ladies, and court jesters of the royal court reign over the climax of the weekend. Prizes are given for the most original and best costumes worn by individuals and groups.

Student-Faculty Softball Classic

At the end of the school year, prior to examinations, representatives of each male social group challenge the faculty to a rough and tumble game of softball. Last year the Faculty All-Stars arose victorious, defeating the Greek Gods by a score of 7 to 6.

Sock Hop

Each year Delta Delta Delta sponsors a backward dance. Proceeds from the Sock Hop are used to provide scholarships for women on campus regardless of sorority affiliation.

Talent Night

Zeta Tau Alpha sponsors Talent Night each year to provide funds for its philanthropic work. Each sorority, fraternity, and independent group is allowed to enter a group act and an individual act. The Mr. Talent and Miss Talent trophies are awarded to the most talented individuals. Trophies are awarded to the sorority and fraternity displaying the best talent.

Beauty Revue

Each year the Lynx holds a beauty revue. The sororities and the Independent Women each enter six participants in the contest which is judged by well-known Memphians. Eleven women are chosen as finalists, and of these five are selected as beauties and six as favorites. The first announcement of the final choices appears in the Lynx.

CAMPUS SOCIAL AFFAIRS

The social committee, which is a committee of the Student Council, is composed of one representative from each fraternity and sorority, one representative from the independent men and women groups, and the Social Commissioner. At the beginning of each new social committee term of office, each member is required to take and pass satisfactorily a test over all the rules regarding campus social affairs. These rules include the use of the fraternity and sorority houses and the use of the gym. This assures the Student Council that each social committee representative has a basic knowledge of campus social rules.

SOCIAL REGULATIONS

1. Each fraternity, sorority, and independent group may have not more than one mid-week social function per semester for such events as outings, banquets, etc., which must be placed on the social calendar at least one week in advance of the event with the approval of the Commissioner of Social Activities. This includes any type of function lasting after 8:00 P.M. Any additional event during the same semester on any night except Saturday is subject to the approval of the Student Welfare Committee. All other functions with the exception of exclusive events (see rule 2) must be held on the particular Saturday nights on the social calendar which are designated for informal fraternity and sorority parties.

2. Petitions for the exclusive reservation of any dates must be submitted to the chairman of the Student Welfare Committee before the end of the first month of each semester. Events cannot be exclusive unless the entire student body is invited. On the nights of these exclusive social events, no other fraternity or sorority may hold a social function. Upon the approval of these dates by the Student Welfare Committee, copies of the social calendar will be filed with the assistant dean of women in advance of the event.

3. No fraternity, sorority, or independent group may schedule any social function on a night when a varsity athletic team is playing a regularly scheduled game on the campus unless the hours do not conflict.

4. All entertainments after 8:00 P.M. which men and women students attend must be properly chaperoned. Married alumni (ae) or parents may serve as chaperons, but it is necessary to have at least one faculty member present. The student organization responsible for each evening party must present to the assistant to the Dean of Women, three days in advance of the social function, the names of those who have accepted the student's invitation to act as chaperon until the close of the party. Failure to turn in chaperons to the Dean of Women's office by 5:00 P.M. three days in advance of the event, will result in a \$10.00 fine being levied on the group concerned. If chaperons are not turned in by 5:00 P.M. on the day before the event, the event will automatically be taken off the social calendar and the group will be prevented from having the event.

5. Alumnae who have been out of college five years may serve as chaperons for slumber parties held in the sorority houses. A report on each slumber party must be handed in to the Dean of Women's office by the chaperon. Each sorority may have one slumber party in the lodge each semester. No slumber parties may be held in the dormitories. All women students and guests attending a slumber party at a sorority house must be in by 1:00 A.M.

6. Saturday parties and dances must close by 1:00 A.M. No social functions may be held on Sunday. For exceptions see rule two which governs the use of fraternity and sorority houses.

7. Within one week after evening parties, the fraternity, sorority, or campus organization sponsoring such parties must present a written report thereof to the Dean of Women's office containing the following information:

- a) the names of chaperons invited and attending.
- b) a report on the conduct of those students attending the party.
- c) the hour at which the event terminated.

Also one of the chaperons present at each event will be requested by the Dean of Women's office to make a report containing this same information. These reports will be made on blanks supplied by the Dean of Women's office.

8. Afternoon teas, dances, "date suppers," or any afternoon parties may be given by campus organizations or classes on any days other than Sundays, but must close not

later than 8:00 P.M. The recreation room of Voorhies Hall is available for such functions. (Arrangements are to be made in advance through the Dean of Women's office.)

9. A sorority or fraternity may have only one open house during a semester, and there will be only one open house during a single week. This restriction does not apply to Homecoming, or other occasions that merit open houses given by all the sororities and/or fraternities for the college as a whole.

Rules Governing Use of Fraternity and Sorority Houses

1. Both fraternity and sorority houses are to be reserved for the exclusive use of men and women respectively during the morning hours and until 12:30 P.M.

2. Whenever a sorority house is to be used after 8:00 P.M. by its members, its alumnae, or for any activity only for women, the Dean of Women must be notified in advance except for Saturday evenings when at least four women must be present.

3. a) Weekdays.

Men and women students are permitted to visit fraternity and sorority houses and men's apartments between the hours of 12:30 P.M. and 8:00 P.M. Whenever any of the above are being visited there should be present three women students, one of whom is an upperclasswoman, and men students may visit sorority houses when there are present in the house visited three women students, one of whom is an upperclasswoman.

b) Saturdays

1) On Saturday evenings when no exclusive dates are designated on the social calendar, fraternity and sorority houses may be open from 8:00 P.M. until 1:00 A.M. for informal, properly constituted, mixed groups without the necessity of chaperonage. Proper chaperonage is still required for a party, which is a planned, organized social event.

2) On a Saturday evening after an exclusive event, houses may be used by properly constituted informal mixed groups. The houses may be opened at the conclusion of the event and remain open until 1:00 A.M.

c) Sundays

Informal mixed groups of students may use the fraternity and sorority houses between the hours of 12:30 P.M.

and 5:00 P.M. The fraternity houses may be used by informal mixed groups on Sunday between the hours of 8:30 P.M. and 11:00 P.M. The fraternity and sorority houses may be used by informal mixed groups on Sunday between the hours named above.

4. Any unseemly conduct in sorority or fraternity houses or failure to conform to the above regulations will result in disciplinary measures on the part of the Administrative Committee.

5. A new rule governing the use of sorority houses has recently been put into effect. Girls may study in the sorority houses each night until ten o'clock as long as there are two girls there and no boys present. This rule is on a trial basis only.

Use of the Gymnasium

1. The date wanted must be registered on the social calendar in the Dean of Women's office well in advance.

2. The Commissioner of Social Activities and Athletic Department must be contacted for their approval.

3. The president of the organization must call at the Dean of Women's office three days ahead of the scheduled event to fill out a permission blank and to advise the chaperons.

4. A \$15 fee must be paid in the cashier's office. Also, a \$10 fee must be paid to the custodian.

5. Decorating is to be done after 1:00 P.M. Saturday unless permission to begin sooner can be obtained from the physical education instructors.

6. Mr. Twaddle, the maintenance engineer, is to be informed well in advance of the event. No decorations are to be used without approval.

7. There will be no smoking in the gym. This rule will be rigidly enforced. **Those disregarding the rule will be asked to leave.**

8. The function must end not later than 12:00 midnight.

9. Decorations must be down and the gym cleaned by 9:00 A.M. the following Monday.

10. No dances other than Homecoming, "S" club, Student Council, and April Fool's may be held in the gym. Sawdust must be obtained for the floor.

11. No coke bottles may be taken into the gym at any time.

EDUCATIONAL ACTIVITIES

The Commissioner of Educational Activities co-ordinates Student Council programs which deal directly with academic education. He provides extracurricular opportunities for students to enlarge their horizons in political, cultural, and other areas. He and the Publications Commissioner are responsible for the **Southwestern Review**. Other programs include:

Freshman Orientation Seminars

The FOS program was inaugurated in order to help the freshman adapt to study on a college level and to interest him in the world affairs. Three discussion groups will be held every other Thursday night as soon as classes begin in September. Members of the faculty and selected juniors and seniors will assist in the program.

High School Visitation Program

A committee of students led by the junior class Student Council representative and another student visits the high schools in the Memphis area and presents programs which show high school students the benefits of a college education in order that more high school students will be encouraged to attend some institution of higher learning.

Debate Club

In its past history the debate team has ranked third in national collegiate competition and has defeated teams from such institutions as West Point and Annapolis. It is hoped that the club will again be able to develop such talents. Faculty advisors are Mr. John M. Hemphill and Mr. Ray Hill.

Southwestern's **Young Democrats** and **Young Republicans** are service organizations composed of students interested in local and national political affairs and in the parties after which the groups are named.

ATHLETICS

The Commissioner of Athletics is in charge of announcing and publicizing all varsity sports events. Serving on the Faculty Athletic Committee, he is the students' representative to that group. Athletic organizations at Southwestern include:

"S" Club

The "S" Club is composed of all men who have earned letters in one of the varsity sports (football, tennis, golf, cross-country, basketball, baseball, and track).

Chairman.....Mike Drake

Men's Intramural Board

The Men's Intramural Board, composed of representatives from the six fraternities and the independent men, is in charge of all men's intramural athletics. It sponsors tournaments among the fraternities and independent groups in flagball, basketball, pingpong, softball, golf, volleyball, tennis, badminton, and track.

Chairman.....Bob Hall

Women's Athletic Association

The WAA controls all women's intramural athletics. It sponsors tournaments between the sororities and independent groups in volleyball, basketball, and softball. Each spring the WAA sponsors a field day when contests are held in archery, badminton, tennis, pingpong, and golf.

Southwestern Athletic Union

The purpose of the Southwestern Athletic Union is to provide for, increase, and maintain that intangible element of college life known as school spirit; to provide a campus-wide organization to which all students may belong and in which each may work towards a unified goal; to actually support through a well organized program, the total Athletic effort of Southwestern at Memphis, including varsity sports, intramural activities, and other events in which a large part or all the student body participates; to encourage attendance of every athletic event and other worthy activities on the campus; to plan and defray costs of out-of-town trips to athletic events; to plan and provide for any and all other such activities as shall be befitting to such an organization.

It is anticipated that the membership of SAU will include the entire student body. The freshman class, as well

as the rest of the student body, will be contacted during the first weeks of school. There will be further explanation concerning the objectives of SAU, and also an opportunity for the members of the freshman class to join.

President.....Mike Whitaker

College Athletic Conference

Southwestern is in its second year as a member of the College Athletic Conference, which also includes University of the South at Sewanee, Tennessee; Washington and Lee University of Lexington, Va.; Washington University of St. Louis, Mo.; and Centre College of Danville, Ky.

The conference became effective with the football season of 1962, with Washington and Lee placing first, Sewanee second, Southwestern third, and Centre fourth. Washington did not compete in football this season, but will do so next year.

The purpose and principles of the conference, as stated in its constitution, reflect the general athletic atmosphere of all members: "The purpose of the College Athletic Conference shall be to provide an association through which the member institutions may encourage organized competition in intercollegiate sports among teams representative of their respective student bodies.

"It shall be a cardinal principle of this conference that all participation in sports by the members of its teams will be solely because of interest in and the enjoyment of the game. No financial aid shall be given to any student which is conditioned upon, or for the purpose of encouraging, his participation in intercollegiate sports."

Sports covered by the conference include football, basketball, golf, tennis, track and field, and baseball. Cross country will be added as soon as is feasible, as will wrestling and swimming.

Coach Jesse L. Johnson—Head Football Coach, Head Baseball Coach

Coach Don Duckworth—Head Basketball Coach

Coach William R. Maybry—Director of Athletics, Head Coach of Cross Country and Golf

Coach Derrick Barton—Head Tennis Coach

Coach Freeman Marr—Track Coach

Coach J. C. Anthony—Assistant Football and Basketball Coach



PUBLICATIONS BOARD AND STUDENT PUBLICATIONS

Southwestern publications include the *Sou'wester*, the weekly newspaper, the *Lynx*, the yearbook, *Stylus*, the literary magazine, the *Student Council Handbook*, and the *Southwestern Review*, a student opinion magazine published in co-operation with the Commission on Educational Activities.

The Publications Board appoints editors and business managers of the campus publications, who are responsible to the board for financial status and the proper conduct of the publication.

Dale Seay.....	President
Mr. C. L. Springfield.....	Treasurer
Professor James McQuiston.....	Faculty Advisor
Lynn Williams.....	Senior Class Representative
Sara Means.....	Junior Class Representative
Susie Danforth.....	Sophomore Class Representative
Don Watson	Sou'wester Editor
Jerry Black	Sou'wester Business Manager
Karen Hardy	Lynx Editor
John Davis	Lynx Business Manager

The Southwestern Review

The *Southwestern Review*, a new publication, gives Southwestern students an opportunity to express their views on current political, religious, and social problems. The first issue will be available in October.

David Feltus	Co-Editor
Jim Houston	Co-Editor

RELIGIOUS ACTIVITIES

Stylus

Stylus is Southwestern's literary magazine. Previously, membership in the **Stylus** organization has been limited. However, plans for this year include making it open to any students interested in creative writing. The editorial board, which chooses the editor and the articles for publication, will be made up of students who have had two articles accepted for publication in a previous **Stylus**.

The Sou'wester

The **Sou'wester** is the school newspaper and is published weekly by a volunteer staff under the supervision of the editor. Its purpose is to keep students informed of happenings concerning the college, mirror a complete and accurate picture of the many aspects of campus life, and serve as a medium by which student thinking on issues pertinent to the student's role in the college community may be stimulated.

For students interested in working on the paper a meeting will be held during Orientation Week, and will be listed among the activities in the Orientation Week Schedule Booklet. Students with a good English aptitude are preferred, but everyone interested is urged to apply.

Don Watson Editor
Jerry Black..... Business Manager
John McQuiston..... Managing Editor

Lynx

The **Lynx** is Southwestern's yearbook, published annually and distributed each May. Its purpose is to capture, primarily pictorially, the events and personalities of each school year and to compile these into a book of lifelong pleasure. The cost of each copy is covered by the activity fee, included in semester tuition.

The Editor and Business Manager are chosen the preceding spring by the Publications Board. They in turn select their staff from experienced and interested applicants, both upperclassmen and freshmen. There are many staff positions, each of which is an excellent opportunity to express and develop individual creativity and a sense of responsibility.

Karen Hardy Editor
John Davis Business Manager
Shirley Haney..... Assistant Editor

Protestant Religious Council

The purpose of the Protestant Religious Council is to keep before the minds of the students of Southwestern the claims of Christian truths and ideals; to stimulate increasing loyalty to and expression of those ideals through honest thought, genuine worship, wholesome fellowship, and unselfish service; and to coordinate the working of all religious organizations on the campus for these ends.

The PRC is a student organization composed of an executive committee and the president and a representative from each of the religious organizations on campus—the Baptist Student Union, the Canterbury Club, the Methodist Student Fellowship, and the Westminster Fellowship. All campus-wide religious activities are directed by and channeled through the PRC, while each denominational organization directs its own program.

Planning and programming are important functions of the PRC. It is responsible for the campus-wide hearth supper and vesper service held the Sunday night during freshman orientation week. It plans, in cooperation with the faculty-student Committee on Convocations and Religious Activities, the fall and spring periods of religious evaluation. It directs the annual Thanks-through-Giving Drive. It holds special worship services and discussion sessions.

Yet the work of the PRC goes further than planning and programming as it seeks to discover purposes through exploration of the meaning and mission of the church. The Christian religion is one which involves relationships with students in whatever areas we are involved and gives meaning and direction to all areas of campus life.

Cam Murchison President
Irvin Haas Vice-President
Genie Heslip Secretary
Jim Collier Treasurer

Westminster Fellowship

The Westminster Fellowship for Presbyterian students meets every Sunday night at Evergreen Church for worship, program and refreshments. The aim of the WF is to provide a Christian fellowship for students, and to witness for Christ in the midst of the ongoing life of the campus. Programs are presented by students and outside speakers.

Methodist Student Fellowship

The Methodist Student Fellowship was organized in the fall of 1952 and meets weekly at 5:45 on Wednesday evening for a religious program at the Chi Omega lodge. The M.S.F. cordially invites all Methodist students to visit or to join the group.

Canterbury Club

The Canterbury Club is the organization for Episcopal students. The group meets once a week for supper and a program. Among the club's projects are bi-monthly communion services and work with Memphis churches.

Baptist Student Union

The B.S.U. was organized in 1953 with the aid of the director of student work in Memphis. The purpose of the B.S.U. is to extend the influence of the church to the campus. The organization meets twice a month on Wednesday evening.

Danforth Program

In September, 1956, the Danforth Christian Service Project was established on Southwestern's campus. This program has as its purpose the training of students for volunteer service and lay work. Students are given training for work in one of several fields—church school teaching, recreation, social service, and literary work. The students are then placed in Memphis churches, hospitals, and social agencies where they receive guidance and further training as they work. The program is under the direction of Mrs. W. M. Cone.

Susan Smith, Billy HuntCo-ordinators



ORGANIZATIONS Honorary

Alpha Psi Omega

Alpha Psi Omega, national honorary dramatic fraternity, provides an honor society for those achieving a high standard of work in dramatics and promotes a wider fellowship for those interested in the college theatre. Students may work toward membership as pledges of the group.

Chi Beta Phi

Chi Beta Phi is a national honorary scientific fraternity. Membership is limited to students majoring in one of the sciences or mathematics who have completed twenty-five hours in their major and a total of sixty academic hours with at least a 3.0 average.

Chi Beta Phi gives a supper for freshmen making "A" in one of the first year sciences or mathematics each year just after the first semester grades are out.

Eta Sigma Phi

Beta Psi Chapter of Eta Sigma Phi, national honorary classical languages fraternity, was established at Southwestern in 1952. Membership is open to students who have an A or B in one semester of intermediate or advanced Latin or Greek. The purpose of the fraternity is to promote interest in all aspects of Greek and Roman literature, art, and life.

Omicron Delta Kappa

ODK is a national leadership fraternity organized to recognize outstanding men in the junior and senior classes. Membership is on the basis of achievement in one of the five phases of campus life: scholarship, athletics, religious and social affairs, music, speech and dramatic arts, and publications. Men students must have an average of at least 2.4 to be tapped. Each May, ODK honors the most outstanding sophomore man selected by the group.

Pan-Olympic

Pan-Olympic, honorary women's athletic association, was founded in 1948 at Southwestern in order to create individual interest in intramural athletics. Membership is by invitation only. Eligibility for membership is based on a point system with points given for time spent and places gained in tournaments.

Pi Kappa Lambda

Pi Kappa Lambda, national honorary music fraternity, rewards and distinguishes outstanding work in the musical field. Alpha Epsilon Chapter at Southwestern is composed of faculty members who elect students not exceeding 20% of any one class on the basis of their records in all subjects. The chapter was established May 14, 1949, and is open only to candidates for the Bachelor of Music degree.

Phi Beta Kappa

Phi Beta Kappa, the oldest Greek letter society in America, was founded in 1776 at the College of William and Mary, Williamsburg, Virginia. The Gamma of Tennessee Chapter was installed at Southwestern on December 5, 1949, the one hundred seventy-third birthday of the society's founding. Election to Phi Beta Kappa is the highest scholastic honor which can be conferred upon a student. To be eligible, a student must have an average of at least 3.5 over seven semesters of approved college work.

Psi Chi

Psi Chi, national honorary psychology fraternity, was established at Southwestern in 1952. Its purpose is to further interest in psychology by affording its members contact with psychology as a profession. Membership in this fraternity, which is affiliated with the American Psychological Association, is by invitation and limited to those with at least a "B" average in twelve hours of psychology.

Sigma Pi Sigma

Sigma Pi Sigma, National honorary physics fraternity, was established on the Southwestern campus last spring. Physics majors in the upper third of their class are eligible for induction.

Student Counselors

The Student Counselors, chosen each spring by their fellow students, assist in the freshman orientation program. Working with the dean of women, these women at-

tempt during the first weeks of school to get each new woman student adjusted to her environment. Counselors meet with their counselees, familiarize them with the different phases of campus life, and advise them.

Torch

Torch, honorary society for senior women, recognizes outstanding women who have attained high standards of leadership and scholarship throughout their college careers. An average of 2.8 is required for membership, which is limited to ten women who are tapped in May of their junior year.

After the first eight weeks of the fall semester, Torch gives a luncheon honoring all women students who have attained a 3.0 grade point average. At an annual backward dance in October, the Torch Dream Man of the year is announced. He is chosen by popular vote of all women students.

Torch honors the most outstanding sophomore woman chosen by the group each spring.

Departmental

Southwestern Singers

The Southwestern Singers, under the direction of the Director of Music, serve both the college and the community, performing for religious convocations, various city groups, television programs, and giving two concerts each year with the Southwestern Orchestra. The high point of the choir's activities is the annual tour in the Mid-South.

Sans Souci

Sans Souci, the French club, was organized to promote an interest in French literature, language, and customs. Advanced French students, French majors, and second year students with a "B" average are eligible for invitation to the monthly meetings.

German Club

The German Club has been organized recently by students in the German department. It seeks to stimulate interest in the German language and increase student knowledge of German thought and customs.

La Cordura

La Cordura, the Spanish club, promotes interest in Spanish language, literature, and customs. In order to be eligible for membership, first year students must have an "A" average and second year students have at least a "B" average. All advanced students are eligible.

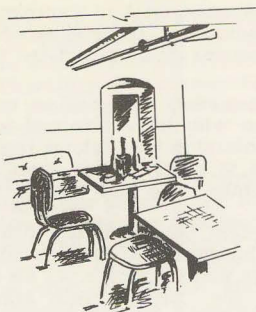

GREEK LETTER ORGANIZATIONS

Six national social fraternities and five national sororities have active chapters at Southwestern. These sororities and fraternities contribute in many ways to the social life of the college. The Greeks hold their meetings and many of their social functions in the sorority and fraternity lodges on Sorority Row and Fraternity Row on the campus.

SORORITIES

WOMEN'S PANHELLENIC COUNCIL

The Women's Panhellenic Council is a joint body composed of the president and two representatives from each sorority. The group works out any difficulties among the sororities and sets up rush rules and regulations each year. The offices rotate among sororities.

Delaine WinterPresident

Alpha Omicron Pi

Alpha Omicron Pi was founded January 2, 1897, at Barnard College, Columbia University, New York. The founders were Jessie Wallace Hughan, Helen St. Clair Mullen, Stella George Stern Perry, and Elizabeth Heywood Wyman. The Sorority now has 70 active and 101 alumnae chapters in the United States and Canada.

The AOPi chapter at Southwestern was founded November 20, 1925, and was named Kappa Omicron after its neighboring chapters, Kappa at Randolph-Macon and Omicron at the University of Tennessee.

Virginia LowryPresident

Chi Omega

Chi Omega was founded April 5, 1895 at the University of Arkansas at Fayetteville. The four undergraduate founders were Jobelle Holcomb, who was a visiting professor at Southwestern for one year, Ina May Boles, Alice Simonds Cary, and Jean Vincenheller. The sorority today has 133 active and 130 alumnae chapters.

Kappa Beta Chapter was founded May 19, 1922, at Clarksville and was moved to Memphis when Southwestern changed sites in 1925.

Kendall KingPresident

Delta Delta Delta

Delta Delta Delta was founded Thanksgiving Eve., 1888, at Boston University by Sarah Ida Shaw and Eleanor Dorcas Pond. The sorority now has 105 active chapters and 282 alumnae chapters located in all states and Canada.

Delta Psi chapter was installed at Southwestern in 1929, after a local sorority, Delta Theta Pi, petitioned the national organization and was accepted.

Anne MoorePresident

Kappa Delta

Kappa Delta was founded October 23, 1897, at State Female Normal School of Virginia (now Longwood College). The founders of the order were Mary Sommerville Sparks Hendricks, Julia Tyler Wilson, Sara Turner White, and Leonora Ashmore Blackiston. Today the organization numbers 101 active chapters and 336 Alumnae chapters.

Alpha Delta chapter, second national sorority on the campus was established April 4, 1925.

Donna Kaye SmithPresident

Zeta Tau Alpha

Zeta Tau Alpha was founded at Longwood College in Farmville, Virginia, on October 15, 1898. The nine founders were Alice Bland Coleman, Ethel Lee Coleman, Ruby Bland Leigh, Frances Yancey Smith, Alice Grey Welsh, Helen Crafford, Mary Campbell Jones, Della Lewis, and Alice Maude Jones. Zeta has 106 active and over 200 alumnae chapters in the United States and Canada.

Beta Sigma chapter at Southwestern was installed May 15, 1929, the 67th chapter in the sorority chain.

Mary Jane HowardPresident

INDEPENDENT WOMEN

The Independent Women is an organization open to all non-affiliated women and "stray Greeks" on the campus. Anyone desiring to become a member may do so by applying to one of the officers.

Marguerite WardPresident

INTERSORORITIES

Southwestern's intersororities have as their purpose the recognition of outstanding sorority women and the promotion of friendly relations among sorority women. There are two national intersororities on campus. Both were founded at Randolph-Macon Women's College. Members attend chapel in the intersorority colors on certain days of the week.

Pi

Every other Wednesday, members of Pi wear green and white with the traditional arm band. Composed of fifteen members, the organization recognizes a May Day Pi as the final new member of the year.

S.T.A.B.

S.T.A.B. is composed of twelve brunets and one blond. On Fridays, members wear red and white with the red ribbon and dagger of S.T.A.B. They honor a Founder's Day S.T.A.B. each March as the thirteenth member.

FRATERNITIES

INTER-FRATERNITY COUNCIL

The Inter-Fraternity Council is comprised of the president and one representative from each fraternity on the campus. This body co-ordinates and regulates activities of the fraternities and is responsible for making the men's fall rush rules. This year's officers are:

Tommy BrooksPresident
Sandy MyattVice President
Arnold PittmanSecretary-Treasurer

Alpha Tau Omega

Founded September 11, 1865, at Richmond, Virginia, by three Confederate Soldiers, Alpha Tau Omega Fraternity is one of the largest social fraternities today, with 121 active chapters.

Established on the Southwestern campus in 1882 when the college was still at Clarksville, ATO was the second national fraternity on the campus.

Lester GoodinPresident

Kappa Alpha

Kappa Alpha Order was founded December 21, 1865, at Washington and Lee University, while Robert E. Lee was president of the college. The group was founded on Lee's principles of Christianity and manly brotherhood. The perpetuation of the heritage of the Old South is foremost in the Order's purpose.

Today the KA's have 91 active chapters. Alpha Epsilon chapter was founded at Southwestern in 1887.

John McQuistonPresident

Kappa Sigma

Kappa Sigma Fraternity was founded in the United States on December 10, 1869, at the University of Virginia in Charlottesville. The Fraternity traces its origin to the year 1400 at the University of Bologna, Italy.

Today Kappa Sigma has 134 active chapters and 79 alumni chapters in the United States and Canada, including two active and one alumni chapters in Memphis. Phi

Chapter, founded at Southwestern on April 12, 1882, during the 482nd year of the Fraternity's existence, was moved to Memphis with the college in 1925.

Gil JonesPresident

Pi Kappa Alpha

Founded at the University of Virginia March 1, 1868, there are now 140 chapters throughout the United States.

The meaningful traditions of Theta chapter began in 1878 when a group of Southwestern students established Pi KA as the first national fraternity on campus. The rich heritage of Theta chapter is commemorated by the Pi KA National Headquarters which lies across the street from the Southwestern campus.

Eddie PruittPresident

Sigma Alpha Epsilon

Born at the University of Alabama, March 9, 1856, Sigma Alpha Epsilon Fraternity is the largest social fraternity. The group, founded by Noble Leslie DeVotie, has 143 active chapters.

Tennessee Zeta chapter was founded November 10, 1882 at Southwestern in Clarksville. The official colors of the fraternity are purple and gold, and the song is "Violets."

Joe DycusPresident

Sigma Nu

Founded at Virginia Military Institute in 1869, Sigma Nu has a chapter in every state of the union except South Dakota and New Mexico. The active Chapters number 135 with 75 alumni chapters and nearly 100,000 living members.

Epsilon Sigma chapter was founded at Southwestern in 1934.

Ken TullisPresident

INDEPENDENT MEN

Last year, the non-fraternity men completely reorganized the Independent Men in order to increase participation in all phases of campus life. New and old students who are unaffiliated are cordially welcome to participate in the activities of this group.

1964-65 Fraternity Rushing Rules

Section I: Rules Concerning Signing Up For Rush and Pledging

1. The fraternity system will be explained to new men students at a meeting with the I.F.C. Tuesday, September 8, 1964 at 2:30.

2. All men students interested in pledging a fraternity must indicate this desire at a meeting of the I.F.C. with new men students on Friday morning, September 13. Students not able to sign up at said meeting will be given until 12:00 noon on Friday, September 11, to do so if they have a valid excuse.

3. New students not signing up for rush as indicated in RULE 2 of this section will not be allowed to pledge until December 1, 1963.

4. Preference cards will be signed Monday night, September 14, immediately after the last rush party.

5. Pledging will be at 6:30 P.M., Tuesday, September 15.

6. A fraternity must notify the secretary of the I.F.C. within seven days of a broken pledge by the fraternity. The person breaking the pledge (or anyone covered in the pledging stipulations in any section of the 1964-65 rush rules) will not be allowed to participate formally or to be affiliated with a fraternity for sixteen school weeks from the date that the secretary of the I.F.C. receives the notice. A man depledged for scholastic reasons may not be repledged by any fraternity until he makes his grades.

7. A fee of two dollars (\$2.00) will be charged to sign up for rush. Failure to pay results in exclusion of the person from rush.

Section II. Rules Effective September 1, 1963

1. No money is to be spent on new men by fraternity men from September 1 until after September 17 except as stated in Rule 1 of Section IV.

2. There will be no rush parties given by or for a fraternity after September 1, except as stated in Rule 1 of Section IV.

Section III. Rules Effective September 11, 1963

1. New men students may not enter fraternity houses from September 11 until after September 15 except to attend rush parties or to attend open houses to which the entire student body is invited.

2. No upperclassmen, except his roommate, may enter a new student's room between the hours of 12:00 midnight and 7:30 A.M. the next morning from Tuesday, September 8 until after pledging, Tuesday, September 15. From 11:00 P.M. September 14 until after pledging September 15, no more than a passing hello may be spoken between fraternity men and new men.

Section IV: Rules Concerning Parties

1. All rush parties will be held September 9, 10, 11, and 16. The rushees will be divided into three equal groups and will go to the rush parties in the order prescribed in the schedule. On the night of September 9 and 10, all new men students (those who have not attended Southwestern prior to June 1, 1964 will be invited to one-hour parties at the houses of all six fraternities, three the first night, and three the second night (September 9: Sigma Alpha Epsilon, Kappa Alpha and Pi Kappa Alpha; September 10: Kappa Sigma, Sigma Nu, and Alpha Tau Omega). On September 11, those who have indicated a desire to pledge a fraternity will be given invitations to forty-five minute parties at the different fraternity houses. All those receiving an invitation to any house must attend the party, and it is mandatory that they remain in their assigned groups. Violation of this rule will result in exclusion of the involved party from rush. The same procedure shall be followed on Monday, September 16 except that attendance at parties to which one is invited shall be optional.

2. No more than \$15.00 per night may be spent on rush parties. The only refreshments which may be served are coffee, soft drinks, potato chips, and two types of chip dip.

3. Only actives, alumni, pledges, and affiliates may be present at the rush parties. Those not members of the chapter shall be designated as such.

4. A calendar of summer rush parties shall be drawn up at the close of the preceding school year. Dates can be changed only by agreement of the fraternities whose dates conflict.

5. All preparation of the cut lists will be done by the three elected officers of the Interfraternity Council in conference with representatives from each fraternity on the day following each rush party.

Section V: Rules Covering Penalties

1. Any fraternity found violating any of the rules of Section I. article six, II, III, IV will be fined \$25.00 to \$50.00 and/or have its house closed for two months, and/or be deprived of pledging privileges for the following year; to be decided by a trial held by the I.F.C.

2. Any new man violating these rules will not be allowed to pledge until December 2, 1965.

3. It is the duty of any fraternity man having knowledge of violation of any of the above stated rules to report the violation at once to the I.F.C.