



VANTRASE

FOOTBALL 1977

September	3	Univ. of Ark.	away
	10	Millsaps	home
	17	Austin	away
October	24	Washington U.	home
	1	Wabash	away
	8	Baptist Christian	away
	15	*Sewanee (homecoming)	home
	22	*Centre	away
November	29	Maryville	home
	5	*Principia	away
	12	*Rose-Hulman	home

* denotes Conference Games

BASKETBALL 1977

December	1	Millsaps	home
	3	Freed Hardeman	home
	7	Christian Brothers	away
January	10	Union	home
	4	Mo. Baptist	home
	6-7	Dixie Tournament ^o	home
	12	Union	away
	14	Freed Hardeman	away
	16	Lambuth	away
	19	Trevecca	home
	21	Sewanee	away

^oUnion, Greenville, Millsaps & SAM



We dedicate this Handbook to The Other Side--the other side of the refectory, the other of campus, the other side of the pool (please, no!), students, faculty, administrators, the greeks, the independents, the "Establishment"...all the "theys." The parts--each distinct--make the whole, giving life dimension and color. Be of light heart; may your years at Southwestern be ones you'll remember and cherish.



The Handbook 1977

li li chung - mary palmer
co-editors

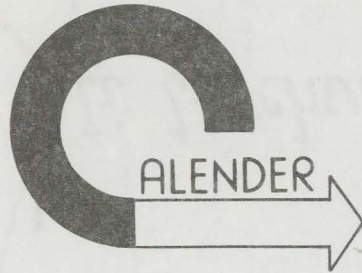

TERM I

M-W, 9/5-7	Orientation & Registration of new students
Tu, 9/6	Registration of old students
Th, 9/8	Classes start
Tu, 9/21	Last day for Pass/Fail and Add/Drop
F, 9/23	Opening Convocation
W, 10/19	Mid-term grades due
F at 5, 10/21	Mid-term Break
W, 10/26	Classes start
W, 11/2	Last day for WP/WF
F-Su, 10/28-30	Formal Rush
Tu-F, 11/15-18	Term II Registration
W noon, 11/23	Thanksgiving Recess
M, 11/28	Classes start
M,W,F 12/5,7,9	Comps
W, 12/8	Reading Day
F-W, 12/9-14	Finals

TERM II

M, 1/3	Classes start (boohiss!) Registration for those who didn't
M, 1/16	Last day for Pass/Fail and Add/Drop
F, 2/10	Mid-term grades due
F, 2/10	Mid-term Break
W, 2/15	Classes start
M, 2/27	Last day for WP/WF
M-Th, 3/13-16	Term III Registration
M,W,F 3/20,22,24	Comps
Th, 3/30	Reading Day
F-W, 3/31-4/5	Finals

TERM III

W, 4/12	Classes start Registration for those who didn't
Tu, 4/18	Last day for Pass/Fail and Add/Drop
M, 5/9	Last day for WP/WF
Tu-Th, 5/9-11	Pre-registration for September
W, 5/24	Reading Day
Th, F 5/25-6	Finals
M,W,F 5/15,17,19	Comps
Su, 5/28	Baccalaureate
M, 5/30	Graduation

Southwestern At Memphis

A college of liberal arts and sciences, founded in 1848

THE PRESIDENT

Dear Southwestern Students:

Welcome to Southwestern!

First, a word to members of the freshman class: It is not easy to graduate from high school as a senior and then start over again at the bottom of the ladder. It is not easy to start a new life-style, but it's worthwhile, and we're glad you are here.

Second, a word to transfer students: You face many of the same changes, but I delight in the experience you bring and welcome your suggestions.

Third, a word to all students: I hope your years at Southwestern will be full with intellectual curiosity, spiritual growth, and good friendships. I hope that you will make Southwestern a better place by being here.

Godspeed,

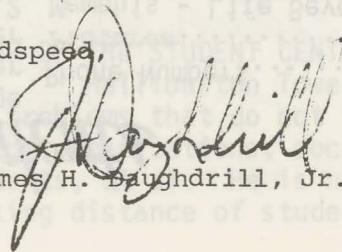

James H. Daughdrill, Jr.

Contents

	page		page
Football Schedule.....inside cover		Phone Numbers.....	19
Basketball Schedule.....inside cover		<i>Pictures</i>	20
College Calendar.....	2	Memphis - Life Beyond Campus.....	23
President's Welcome.....	3	Money Matter\$	
Table of Contents.....	4	Cashier's Office.....	27
Who's Who in Administration.....	5	Finance Office.....	27
Map of Campus.....	6	Financial Aid.....	27
Absences.....	7	Extras.....	28
Academics.....	7	RA's.....	28
Admissions.....	8	Registrar.....	28
Alma Mater.....	8	Security.....	29
Athletics.....	8	Social Life.....	29
Administrative Services.....	10	Student Center.....	30
Bookstore.....	10	Student Organizations	
Camping.....	11	Black Student Association.....	30
Commons.....	12	Campus Art Council.....	30
Counseling.....	12	Dilemma.....	31
Dorms.....	13	Drama.....	31
Eat		Honor Council.....	31
Eat In.....	13	Kinney.....	32
Eat Out.....	14	Musician's Outlet.....	33
Fisher Gardens.....	16	Photography Buffs.....	33
Infirmary.....	16	Publications.....	33
International Students.....	16	Southwestern Fellowship (SF)...	35
Jobs.....	17	Social Regulations Council.....	36
Library.....	17	Student Government Association	36
Lost & Found.....	18	Wheels.....	39
Mail.....	18	WLYX.....	40
Maintenance.....	18	Who & Where for Whatever.....	
		Afterword & Staff Credit.....	41

Who's Who

PRESIDENT OF THE COLLEGE

James H. Daughdrill, Jr.
Halliburton Tower, third floor

The President is the spokesman of the college to the Board of Trustees, alumni, and the community as well as chief officer of the administration and faculty. Receptive to student opinion, interest and suggestions, he can be found walking around campus in his spare time, which is becoming more scarce. The secretary will make appointments for those with special concerns.

DEAN OF THE COLLEGE

(Acting) Charles O. Warren
Halliburton Tower, second floor

Working with faculty, the Dean seeks to maintain the variety and standards of the educational program, to secure new faculty members, and to safeguard student and faculty freedoms and interests. He also deals with "exceptions" to ordinary academic procedures (such as changing exam schedules), the Dean's List (3.75+ during Terms I and II), students placed on academic probation or suspension. The Dean welcomes suggestions and is happy to make appointments with individuals concerning academic matters.

DEAN OF STUDENTS

Anne Marie Williford
Halliburton Tower, second floor

Dean Williford offers all assistance at her reach to all students. This is the office to find when in any kind of bind or simply when seeking a helping hand. Her office hours are posted, and appointments can also be made. She deals with most residence halls structuralism and other red tape.

ASSISTANT DEAN OF STUDENTS & DIRECTOR OF THE STUDENT CENTER

Bo Scarborough
Halliburton Tower, second floor & around

Bo handles the student-related problems that do not fall within the realm of Dean Williford. This includes student organizations, social programming, the calendar, student counselors, town students, et al. He is not hard to get in touch with, always within shouting or talking distance of students.

Campus

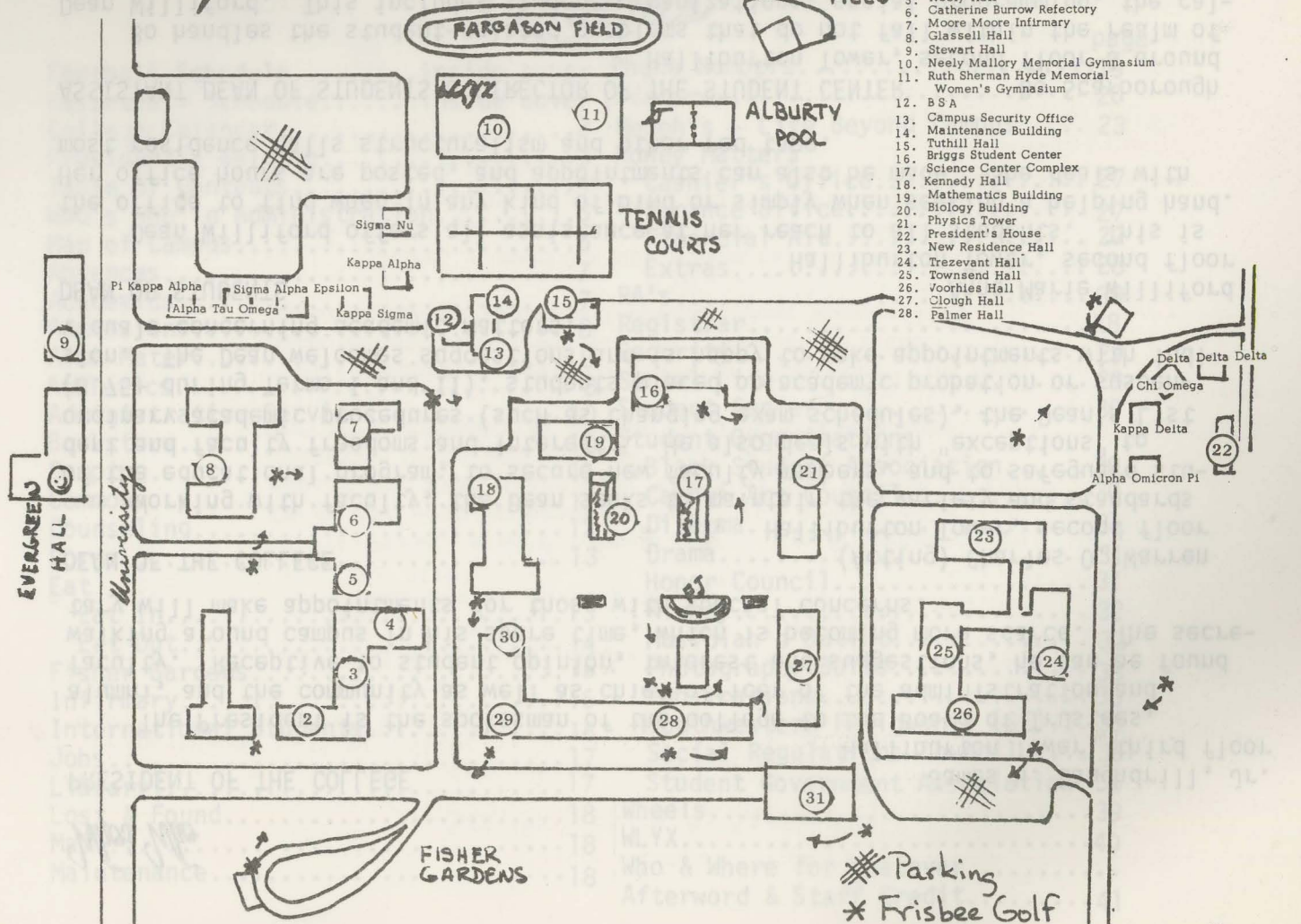

Absences

The college expects but does not itself enforce daily class attendance by the students. Any professor may, and some do, require class attendance if he/she so desires. Speak with your professor regarding his/her policy. (They're generally good people. ed.)

"Leave of Absence" should be discussed with Dean Ray Allen of Admissions.

Academics

Your best plan is to "know your catalog," it will save you time and worry. On pages 38 to 46 of your 77-78 catalog are the requirements for graduation and academic regulations of the college. Read them carefully.

During orientation, you will find out who your colloquium leader is, and he/she will serve as your faculty advisor. This simply means they will assist you in planning the courses you want to take and should take. Fellow students (upper-classmen), however, are also a very valuable source of information, they can tell you what a professor is like (great, easy, boring, spacy, etc.) and what the class will entail (papers, tests, etc.). Your student sources of information are professors and department chairmen, they can best tell you about their courses, their departments, and what kind of career might be available. *Applicable to old and new students: take advantage of all these sources of information, everyone will be happy to help you.*

Any questions you have concerning the requirements for a major in a certain department should be directed to the chairman of that department (whose name is noted at the beginning of each department section in the catalog). Exceptions to academic requirements may be directed to Curriculum Committee, Prof. Robert Llewellyn, chairman.

Double majors and joint majors can be worked out (diversity and the dumps, ed.). Programs in the latter group are Psychobiology, Econ-Math, Econ-I.S., Business-I.S.

Admissions

You (that means new and old students) can help Admissions in 3 ways:

- (1) Giving names, addresses and high schools of prospective students to Admissions.
- (2) Talk about SW to your high school friends.
- (3) Following up contacts and giving tours on campus. Stop by 100 Palmer and tell Mary Jo Miller if you are interested.

Dean of Admissions: Ray M. Allen 102 Palmer

Director of Admissions: Mary Jo Miller 100 Palmer

Alma Mater

Dear Alma Mater, kind the fate
That links our lives with Thee,
For God's own power that made Thee great
Is the truth that makes us free;
Thy torch has touched our hearts with flame,
Our yearning souls refined;
Through Thee we learn the higher aim,
And train the truer mind.

O Leader to the larger light,
Southwestern, 'neath Thy wings
Thine own in rev'rent love unite,
And each his tribute brings;
And dreams, such dreams as old can
dream,
Keep lighted in our hearts the flame
Once kindled there of Thee.

Athletics

A new feeling of pride and enthusiasm surrounds the SAM Athletic program, governed by the NCAA and the College Athletic Conference composed of Principia College, Rose-Hulman Institute, The University of the South, and Centre College. The CAC stresses the concept of athletics on a non-scholarship basis.

The Athletic Department offers a wide range of physical education courses including yoga, horseback riding, ballet, canoeing, weightlifting and raquetball. Check your catalog for a complete listing. P.E. is not required but four hours of credit can be obtained towards graduation and you can have fun doing it.

Over two thirds of the campus participate in intramural sports such as flag-ball, volleyball, basketball and softball. It looks like swimming will become a big splash in the new Alburty Pool. Other competitions are also held throughout the year, so check with intramural directors, Kathy Whitaker and Jim Bigelow.

On the varsity level, Southwestern competes against a wide variety of colleges and universities in the Midwest area. Men's sports include football, soccer, cross country, basketball, baseball, tennis, golf, and track and field. For the women, varsity basketball finished 4th in the state, volleyball was 2nd; and in tennis, SAM was the state champion. If you feel you have the ability to compete on the varsity level, don't hesitate to contact one of our fine coaches:

- Dick Thornton - Athletic Director & Head Football
- Larry White - Assistant Football
- Herb Hilgeman - Head Basketball
- Sepp Huber - Head Soccer
- Sarah Ann Risser - Basketball & Tennis
- Jack Taylor - Tennis
- Bill Maybry - Cross country & Golf
- Gary Troll - Head Baseball
- Will Sweetzer - Assistant Baseball
- Freeman Marr - Head Track

The new season begins with the opening home football game against arch rival, Millsaps College on September 10th. See you there!!

HOURS:

Gym:	Monday thru Thursday	9:00 a.m. - 10:00 p.m.
	Friday thru Saturday	9:00 a.m. - 5:00 p.m.
	Sunday	1:00 p.m. - 5:00 p.m.

Tennis & Racquet

Ball Courts: same as gym.

But you must make reservations with Athletic Office, up to 24 hours in advance.

Track: daily 9:00 a.m. - 5:00 p.m.

Pool:

Director: Lynda Gayle Deacon

Monday thru Friday noon - 6:00 p.m.

Saturday 10:00 a.m. - 6:00 p.m.

Sunday 1:00 p.m. - 6:00 p.m.

Remember: no cut-offs, alcoholic beverages, food or glass containers. Limit one guest per day at \$1 per guest.

Important: carry student I.D. card at all times in order to obtain equipment, use facilities and for identification purposes.

Administrative Services

Director: Tom Kepple

This office handles matters concerning college administrative and maintenance personnel, insurance, purchasing, and guest rooms. Go by and talk to them (real nice folks) if you need info on "procedures."

Hours are: 8:30 a.m. - noon; 1:00 - 5:00 p.m. Monday thru Friday

Bookstore

Manager: Jane Darr

The Bookstore is located on the west side of Student Center. Lines are long at the beginning of the term; plan to spend time and money there.

Hours are: September thru May - 8:30 a.m. - 4:00 p.m. Monday thru Friday

June thru August - 10:00 a.m. - 2:00 p.m. Monday thru Friday

Services include textbooks, recommended reading material, general reading

wide range of supplies including art supplies

college sports wear

health and beauty aids

film and film processing

postage stamps, postcards, aerogrammes

gift items, stationery, record albums, art prints

flower and candygram orders

*textbook buyback: the Bookstore will offer to buy back, at the end of each term, textbooks no longer wanted by students. Good time to pick up bargains for next term's books; you can also put up signs of what you need.

Full refund will be given on all unused, clean, unmarked textbooks, with cash register receipt within ten days following the start of the term. Sales of general reading books and all other merchandise are final with the exception of defective merchandise.

Camping

The SGA and Student Center have purchased some equipment that students are welcome to use for a small fee to cover wear and tear. Reservations are essential and can be made at Student Center office. Items available are:

2 two-person tents (50¢ per night)	1 fuel flask	free!
2 down bags (50¢ per night)	2 back packing stove	(25¢ per night)
4 back packs (50¢ per night)	1 lantern	(25¢ per night)
assorted pots & pans	free!	1 axe (25¢ per night)
2 cook kits	(24¢ per night)	

Only earthquakes and grizzly bears are excuses for damages.

A state park would probably be the place to pitch a tent for a few nights such as at Natchez Trace (a little over halfway between here and Nashville). Many parks have cabins for rent, inexpensive especially if you split costs between a few people. You can get an idea of what's to be had in state parks from maps of Tennessee, Missouri, Arkansas and Mississippi.

If you want to go canoeing, caving, rock climbing or backcountry backpacking, you'd better plan on at least 4-5 hours driving-time into Arkansas or Missouri. For canoeists, beautiful rivers--Buffalo, Spring, and Eleven Point Rivers and Big Piney Creek--in northern Arkansas and Missouri are well worth the drive. A group of local canoeists, the Bluff City Canoeing Club (Tel: 732-3700, Tom Kinnon; also puts out *River Guide*), has more specific information on these and other areas, and can also give you readings on water levels and river conditions.

There are some fine backpacking areas in Arkansas and Missouri--Richland Creek, the Buffalo River Wilderness area, Lost Valley State Park (waterfalls and unusual rock formations), and the Blanchard Springs-Gunner Pool area (around Mountain View, Arkansas; has caverns and good rappelling cliffs).

Also, camping stores around here (e.g. Camper's Corner) are helpful with information, suggestions, and names of people to get in contact with.

Commons

Like it or not, as a SW town or dorm student, you are a member of one of the four non-restrictive social groups known collectively as the Commons. The Commons are:

- Robb Common - residents of Robb, White, Ellett and Bellingrath
- Voorhies Common - residents of Glassell and Voorhies
- New Common - residents of New Dorm and Townsend
- University Common - residents of University, Evergreen and Trezevant

The Commons system provides an opportunity for "commoners" to form intramural teams, have parties, poetry readings, and plan get-togethers for just about anything of "common" interest. Fill your calendar by meeting people or simply have fun with your and other Commons.

Counseling

Rm. 305 Student Center

Fred Pultz - career planning (home: 685-7191)

Dennis Heitzman - personal counseling (home: 276-6084)

The Counseling Center provides personal and confidential as well as career counseling and testing. Dr. Pultz and Dennis hold seminars during the year (how to study, transactional analysis). There is also a wide selection of college catalogs from across the nation. An additional service is the job placement bulletin board in the Lynx Lair. Some of the most recent openings are listed in 301 Student Center.

Dorms

For Men:

University: open to women 8 a.m. to midnight.

Townsend: open

Glassell: open

Robb: open

White: open

Ellett: open

Evergreen: open

For Women:

New Dorm: open to men 8 a.m. - midnight

Trezevant: 1st floor open to men 8 a.m. to midnight; 2nd, 3rd floors open

Voorhies: open

Bellingrath: open

Neely: guest rooms

Beds in men's dorms, particularly Glassell, are oversized beds, so you might want to bring larger fitted sheets.

Pets must be strictly of the aquarium or cage variety. Plant and flowers are okay, of course. Last year, New Dorm had to be evacuated twice for flea extermination because someone who lived there had a dog; all the swatting and hassle was no-o-o-o-o-o fun.

All dorms will be closed during Christmas, Spring Break and part of summer.

Eat

Eat In

REFECTORY

The place where minds and stomachs meet, the refectory takes more verbal abuse than any other thing on campus. But guess what? A new food service will be providing campus meals this fall. Epicure (a weird name. ed.)--a small, new and very enthusiastic company--has plans for picnics, banquets, and new dishes to relieve the monotony plus a steak night on different days of the week. Also, there will be some system where you may get tickets for at least one meal a day at the Lair so you can make full use of the Pub (hey, hey!).

No identification card is necessary, but if you're not a dorm student, the Honor System requires that you pay for your food.

Meal hours:

	Monday - Thursday	Friday	Saturday - Sunday
breakfast	7:30 - 10	7:30 - 10	8:30 - 9
lunch	11:30 - 1	11:30 - 1	12 - 1
dinner	4:30 - 6	4:30 - 5:30	4:30 - 5:30

LYNX LAIR

From hamburgers to yogurt, the Lair serves an interesting variety of food at reasonable prices. The Lair has become the special gathering place for faculty and town students. At night, the Lair often draws those on a study break, bridge players, and other goof-offs.

PUB

Hours:	weekdays	4:00 - 6:00 p.m. and 9:00 p.m. - midnight
	weekends	4:00 - 6:00 p.m. and 9:00 p.m. - 1:00 a.m.

Recent addition to the Lynx Lair; serves draft beer (Stroh's regular & dark, Miller Lite, Heineken), soft drinks and munchies.

Eat Out

Barbecue. The *City of Memphis* once wrote (7/76): "New Orleans has its gumbo; San Francisco, its fish; New York, its delicatessens; and San Antonio, its chili; but Memphis, soulful center of southern cuisine, has its barbecue. . . The Bluff City is the Barbecue Capital of the Country." As a guide to beginners, the following establishments are recommended: Will's House of Citterlings, 949 Porter; Lamb's Eat Shop (lunch only) 232 Cleveland; and Charlie Vergo's Rendezvous,

Fast Foods

Wendy's
Kentucky Fried Chicken
Burger King
Krystal
McDonald's
Lynx Lair
Church's Fried Chicken

Donuts & Ice Cream

Dunkin' Donut
Donut Man
Thorton's Donuts
Baskin Robbins
Dairy Queen
McLean Bakery
Rosie's

Late Night

Pat's Pizza
Krystal
The Rendezvous
Kentucky Fried Chicken
J-Waggs
Tony's Pizza

Pizza, Subs & Sandwiches

Roy White's Pizza
Raleigh Pizza Inn
Shakey's
Tony's Pizza & Roasta-Beef
Pat's Pizza
The Overton Hero
Danver's Ranch House
Colletta's
Pete & Sam's
Pasquale's Pizza
Super Submarine Shop

Drinks

J-Waggs
Big Daddy's
Hot Air Balloon
MS River Company
P.O.E.T.S.' Corner
Bombay Bicycle
Polo Club
Alex's
Casey's
Friday's
P & H
Procape

All-you-can-eat on

Special Days
Shoney's
Clark Station
Lobster Feast
Hungry Fisherman
Holiday Inn Buffets

Restaurants

EXPENSIVE (but impressive)
(\$10 up each)
(take parents)

MODERATE
(\$4-\$6 each)

CHEAPO
Informal
(\$4 less each)

Justine's
The Four Flames
Clark Station
Lobster Feast
Victoria Station
Sachi Japanese Steak House
Cafe St. Clair
Fiddler (Kosher)
Pyrenees
Luau (Polynesian)

Paulette's
Grisanti's
Rendezvous
Ireland's
Jolly Ox
Magic Pan
Wild Mushroom
Public Eye
MS River Company
Peking Chinese
Aligahpo's
P.O.E.T.S. Corner

Buntyn's Cafe
Dino SW Grill
Ferguson's
The Spaghetti Store
T.G.I. Friday's
Fabians
Intl House of Pancakes
White Station Cafe
Poor & Hungry (P & H)

Fisher Gardens

A quiet place for self-reflection, deep thoughts, picnics and frisbees.

Infirmary

The Infirmary has 13 beds with 24-hour health care extended to all full-time students living on or off campus. RA's will handle any night emergencies with their Lone Thermometer. Bring aspirin and Pepto Bismal (for exams! ed.). Flu shots and epidemic vaccinations are given when appropriate for a small fee; watch for announcements. The Infirmary also helps students set up appointments with doctors. Student Health Insurance claim forms may be obtained from Ms. Daney Staub of Administrative Services.

College physicians are available at different times each day but are usually there for a few hours each morning (about 9). Bring your own Ace bandages so you won't have to buy one during the flagball or basketball seasons.

Hours:	weekdays	8:00 a.m. - 10:00 p.m.
	weekends	8:30 a.m. - 10:00 p.m.
	doctors' hours vary	

International Students

Southwestern sports nine international students from Nigeria, Cameroons, West Germany, India, Greece, Venezuela and Taiwan. For the past two years, the International Food Fest (plus music and dance) was organized by international and interested students and had good turnouts. There's alot to learn from each other so students are encouraged to intermingle.

New international students should direct all questions--academic and other-wise--to Professor Jim Vest, Rm. 413 Physics Tower. You can also benefit from the experiences of other international students.

Jobs

Job placement services are "wanted" cards on bulletin boards in Student Center and elsewhere, local newspapers, word of mouth, and financial aid office. Other good sources of info for summer or permanent jobs are professors and Alumni Office. Volunteers are needed to help Counseling Office type "wanted" cards; it'll help us all.

Library

Many students study here as there are large tables in the reading room, carols in the stacks, and comfortable couches in the lounge downstairs.

Hours:	Monday thru Thursday	8:00 a.m. - midnight
	Friday	8:00 a.m. - 10:00 p.m.
	Saturday	12:30 p.m. - 5:00 p.m.
	Sunday	1:00 p.m. - midnight

Books are checked out (*and you'll need your I.D. card for this*) for 2 weeks with fines at 5 cents per day. (Note: the fine is one-half if paid at the time of returning or rechecking the book.)

Reserve books ("Man" students check this) may be checked out for 2 hours and for overnight after 4:30 p.m. Overnight due time is 10:30 a.m. the next morning with huge fines of 25 cents for the first hour and 5 cents every hour thereafter. (There's a lot over there if you take time to explore: private study rooms upstairs, *Playboy*, records, etc.). Be sure and ask for the reference librarian if you can't find something.

Many students go to the Memphis Public Library on Peabody and McLean which is a great escape from campus. Its disadvantage is its 9 p.m. closing hour. It is in cycling distance. The Memphis State Library is farther but just as good. SW students can check books out there so books aren't too hard to find if you check all three libraries. Chemistry, Math, and Physics departments have journals libraries in their buildings open to students with a prof.'s OK (good for "all-nighters", ed.)

Lost and Found

First, check where you might have left it--refectory, classroom, under your bed . . . Then try Cashier's Office, Security, Student Center Office, and your RA. Lost I.D. cards, go to Registrar's; lost keys, Dean of Students and Security. The SFA often has info, so check there.

Mail

Student mailboxes are located at the west rear door of Student Center. Both resident and town students are assigned mailboxes during registration in fall. New students entering at other times of the year should check with personnel of the Mailroom.

Incoming mail is delivered to the campus by the U.S. Postal Service Monday thru Saturday (during academic year) at 8:00 a.m. Mail is sorted and student mail is put up by 10:00 a.m.

The purpose of the Student mailboxes is to provide of distributing all U.S. and official campus mail. They may not be used for personal notes; use bulletin boards in the Student Center and in the residence halls for this.

Outgoing mail (other than parcels) may be deposited in the drop boxes located opposite Security Shack, near Refectory (mail pick up at 1:00 and 4:30 p.m. on weekdays, 1:00 on Saturdays). Postage stamps may be purchased in the Bookstore; but there are no facilities there for wrapping or weighing parcels, try Cashier's.

Maintenance

The FIX-IT place located in the same shack as Security. Work orders should be placed with your R.A. to be properly processed. Emergencies receive special attention. Maintenance cannot loan tools or equipment, however, because these are personal property of their workmen.

RESIDENCE HALLS - Men

Ellett Hall.....		278-9108
Glassell Hall.....	First Floor.....	278-9146
	or.....	278-9193
	Second Floor.....	278-9200
	or.....	278-9091
	Third Floor.....	278-9074
	or.....	278-9049
Robb Hall.....		278-9284
Townsend Hall.....	First Floor.....	278-9084
	Second Floor.....	278-9298
	Third Floor.....	278-9125
	Social Room.....	278-9126
White Hall.....		274-9948
Evergreen Hall, all apartments.....		274-9727

RESIDENCE HALLS - Women

Bellingrath Hall.....	First Floor.....	274-9900
	Second Floor.....	274-9910
	Third Floor.....	274-9941
Trezevant Hall.....	First Floor.....	278-9068
	Second Floor.....	278-9080
	Third Floor.....	278-9103
Voorhies Hall.....	First Floor.....	278-9276
	Second Floor.....	278-9162
	Third Floor.....	278-9296
	Social Room.....	278-9133
New Dorm (lobby).....		274-9968

Dean Bo Scarborough

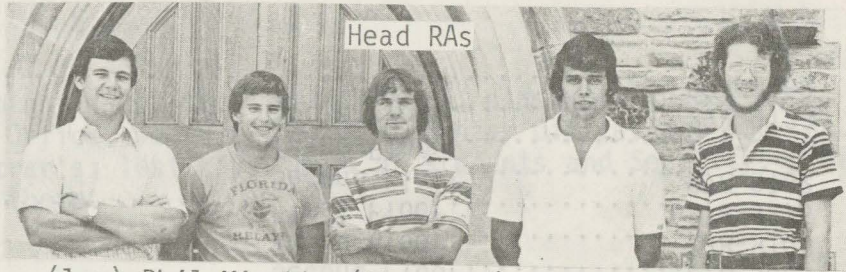

Head RAs

(l-r) Phil Mischke (Townsend), Ralph Jones (Univ.-Evergreen), Marshall Crenshaw (Glassell), Steve Masters (Robb, White & Ellett), Steve Minor (Admin. RA)

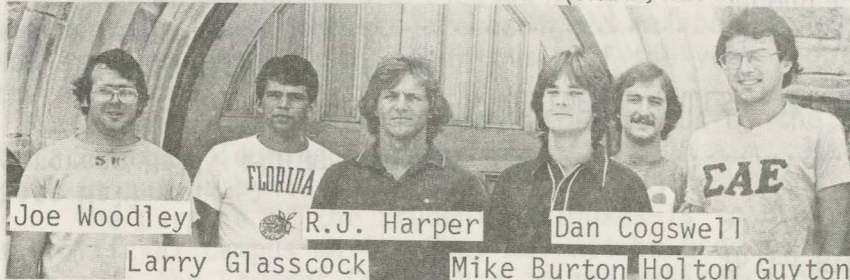

Joe Woodley

R.J. Harper

Dan Cogswell

Larry Glasscock

Mike Burton Holton Guyton

Asst. RAs for Glassell



Asst. RAs

(l-r) Bob Engle (Robb), Joe Pevahouse (White), Brian Burkhardt (Ellett); Andy Falls, Taylor Phillips, & Dave McWilliams (Townsend)



Dean Anne Marie Williford

Pictures

Thanks to
photographer Bill Nolan



(l-r)

Melissa Gibson (New), Stephanie Chambers (Trezevant),
 Frances Clevenger (Bellingrath), Li Li Chung (New),
 Mary Lee (Voorhies), Mary Palmer (Voorhies), Carolyn
 Crenshaw (Bellingrath)



Jimmy Singleton Lady Ray
 Kinney Coordinators



Mr. John Turpin,
 Registrar



President Daughdrill



John Worden
 Lynx Editor

Dan Cogswell,
 SRC President



Holton Guyton
 SGA President



Steve Minor
 Sou'wester Editor

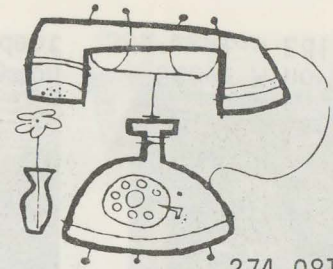

Admissions Office (nights & weekends).....	274-0819
Athletic Office (nights).....	274-3278
Black Student Association.....	278-6353
Counseling Service.....	276-4056
Dilemma.....	276-3898
Infirmery (night & weekends).....	274-3040
Library (night & weekends).....	274-3684
Radio Station WLYX.....	272-1232
Refectory.....	278-4925
Security (24 hours a day).....	274-0036
Student Center.....	274-9984

FRATERNITY HOUSES

Alpha Tau Omega.....	278-9231
Kappa Alpha.....	276-1834
Kappa Sigma.....	
Pi Kappa Alpha.....	278-0543
Sigma Alpha Epsilon.....	278-9054
Sigma Nu.....	272-3891

SORORITY HOUSES

Alpha Omicron Pi.....	458-5669
Chi Omega.....	458-7823
Delta Delta Delta.....	327-5805
Kappa Delta.....	458-5474

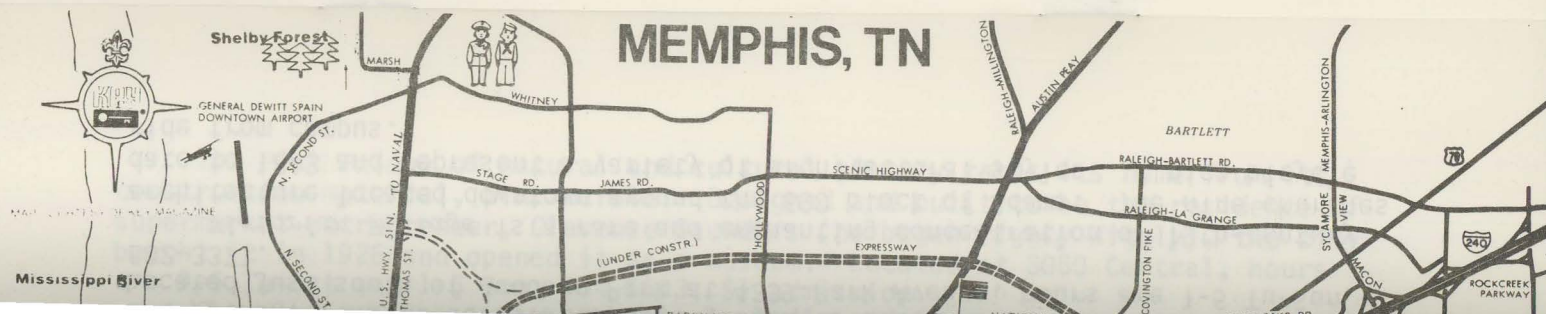

MEMPHIS, TN

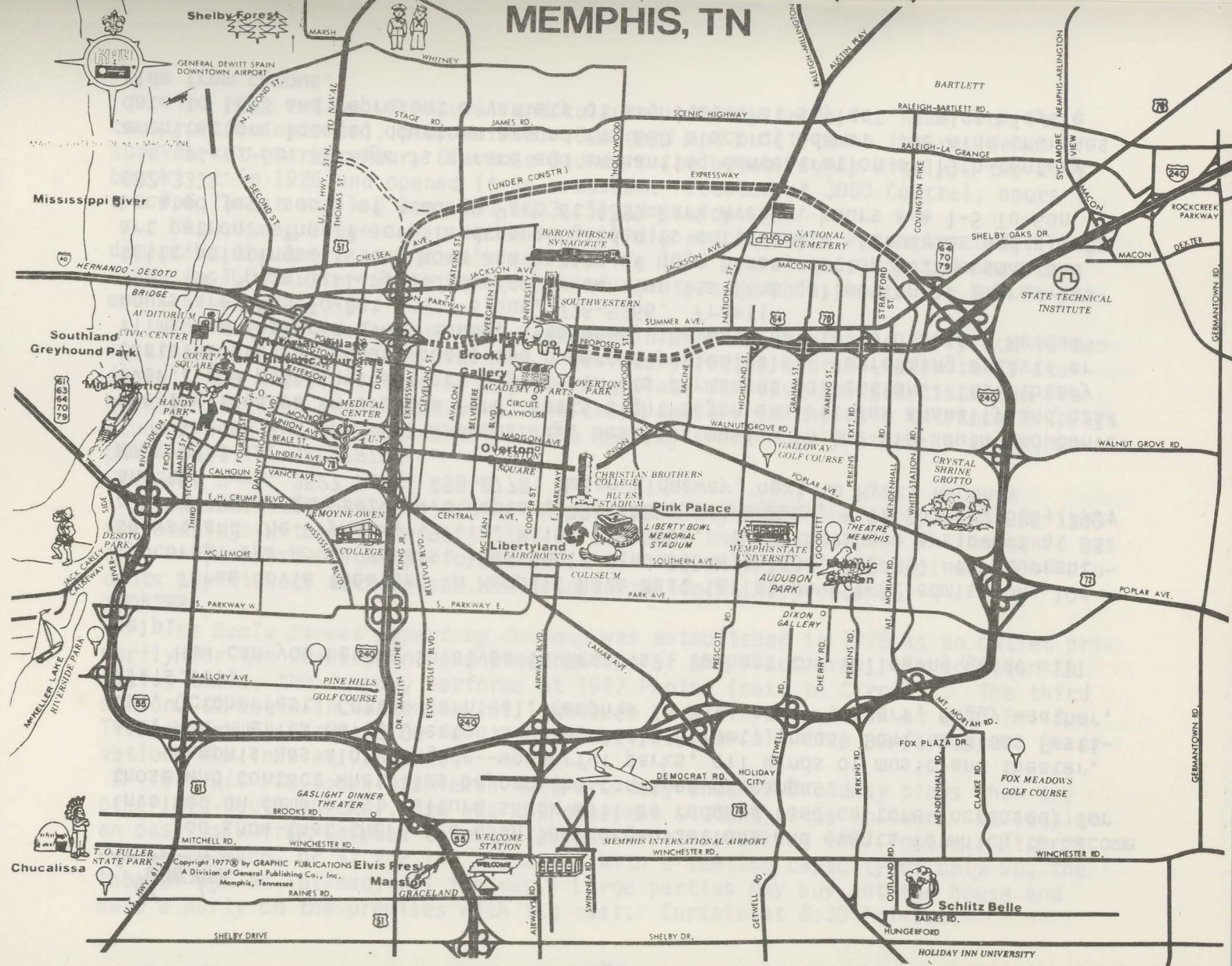

Chucalissa

Copyright 1977 by GRAPHIC PUBLICATIONS
A Division of General Publishing Co., Inc.
Memphis, Tennessee

Elvis Presley
Mansion

Schlitz Belle

Memphis

Life Beyond Campus

You know that there are countless organizations and events in which to become involved on campus but culture shock will be reduced (and culture increased) for those who contact what lies beyond the confines of campus.

Memphis has alot to give--wonderful parks, all kinds of music and theater, art, Mid-America Mall, Overton Square, Beale Street, annual Schlitz Blues Festival, Octoberfest, Cotton Carnival, Memphis In May, crazy drivers, muggy weather, Elvis.....

How can you become involved in Memphis? Perhaps the following guide will help:

MOVIES

Three movie theaters in Memphis have beat inflation (\$1-\$2 admission; 10¢ popcorn): *The Movie Houses*, 1705 Poplar and 535 Highland, 722-8111 for current shows; and the *Orpheum*, 197, S. Main, 526-3052. The others are a rip-off at \$3 a head: *Malco Quartet*, 3473 Poplar, 454-1185; *Faire Four*, 5117 Summer, 685-7790; and the *Park*, 3527 Park, 458-8778: Malco Ridgeway, next to Hyatt Regency

MUSEUMS & ART GALLERIES

The *Brooks Memorial Art Gallery*, best art museum in the Mid-South and conveniently located in Overton Park, hosts eight major exhibitions annually and has over 2,500 paintings and art objects in its permanent collection. Its library contains over 4,000 art books and numerous periodicals. Performing artists or films are featured every Sunday afternoon, the best day to go browse. Museum hours are 10-5 Tu-Sat and 2-5 Sun, 726-5266. Free!!

The *Dixon Gallery and Garden*, known for its fine collection of Impressionistic paintings, is the home and estate of Hugo Dixon, cotton businessman and art patron. The 17-acre landscaped garden is dotted with statuaries and plants. Located just south of Audubon Park at 4339 Park Avenue, hours are 1-5 Tu-Sun, 682-3371.

Victorian Village is a rare and enchanting concentration of 19th-century architecture located downtown around the 600 block of Adams. The nine churches date to 1843 and represent a variety of architectural styles. A nice bicycle ride from campus.

The *Pink Palace* of natural and cultural history takes its name from its construction material, pink marble. Designed and built to be the residence of supermarket entrepreneur, Clarence Saunders (he began Piggly Wiggly), the city bought it in 1926 and opened it as a museum. Located at 3050 Central, hours are 9-5 Tu-Sat and 1-5 Sun, 454-5693, \$1 admission.

The *Pink Palace* of natural and cultural history takes its name from its construction material, pink marble. Designed and built to be the residence of supermarket entrepreneur, Clarence Saunders (he began Piggly Wiggly), the city bought it in 1926 and opened it as a museum. Located at 3050 Central, hours are 9-5 Tu-Sat and 1-5 Sun, 454-5693, \$1 admission.

Chucalussa began as an archeological dig and is now a reconstructed village depicting the American Indian's way of life 1000 years ago. Located near the river in T.O. Fuller State Park south of downtown Memphis, hours are 9-5 Tu-Sat and 1-5 Sun, 785-3160.

The *Memphis Academy of Arts*, located in Overton Park, is a fully accredited institution of higher art training. Besides offering courses (open to SW students), the *Academy* serves as a gathering place for developing artists and frequently features guest lecturers. The small gallery in the main entrance displays student work and changes monthly. The *Academy's* art supply store is among Memphis' best.

SYMPHONY

Season ticket holders of the *Memphis Symphony Orchestra* enjoy eight delightful evenings with renowned artists; as a bonus, the Philadelphia Philharmonic was also in Memphis. Eight performances in all for only \$25. A large number of students buy tickets each season, so transportation is no problem.

THEATRE

The *Beale Street Repertory Company* was established in 1975 as an outlet primarily for the development and presentation of the black arts. In addition to making tours, the *Company* performs at 1947 Poplar (next to Circuit). The third season, to begin in September, will include five plays; curtain at 8:30 Fri-Sun. Tickets are \$3 each; \$2.50 for ten or more; \$20 for all five performances. Reservations and info at 726-9429.

Circuit Playhouse premieres more Broadway and Off-Broadway plays than any other Mid-South theater, and has the cheapest student rates in town. It is also an easy walk from campus, directly across Overton Park at 1957 Poplar. Tickets are \$2.50 each, or \$2 for ten or more. With a seating capacity of only 98, the theater has an intimacy all its own. Large parties may buy out the house and have a party on the premises with the cast. Curtain at 8:30 Fri-Sun.

Casting is completely open and ambitious theater students are encouraged to try out. Art students may display their works in the theater's gallery by making reservations and paying 15% of any work sold. For info and reservations, call 726-5521.

An evening at *Gaslight Dinner Theater* is an "impressive date" that includes buffet dinner (all you can eat), 7-8; and a comedy play, 8:30; all for \$10.35 per person, \$11.40 on weekends. Located at 1110 Brooks Road, call 396-7474.

Playhouse on the Square offers the finest in theatrical entertainment as the only professional resident theater in the Mid-South. Located about a mile from campus on Overton Square (Madison at Cooper), an evening at *Playhouse* can easily include dinner or drinks at any of the nearby restaurants and bars. The *Playhouse* has two bar lounges where patrons can enjoy refreshments or discuss the play with friends and cast.

The special season ticket rate, a bargain at \$17.50, covers seven admission coupons which can be exchanged for reserved seats individually or all at once, plus seven 15% discount dinner coupons redeemable at Overton Square restaurants. Individual tickets are \$4 and \$5 (\$1 off on Thursdays), and any stub entitles the holder to a happy-hour drink at Bombay Bicycle or Friday's after the show. Curtain time is 8:30 Wed-Fri and Sunday; 6:30 and 10 on Sat, 726-4656.

Theatre Memphis was named best community theater in the national competition last season. The theater's 57th season (September to June) will begin with long-running Broadway musical, *Shenandoah*, and five other productions. Individual performances are \$2 for plays; \$3 for musicals; and \$10 for season. Located about 5 miles from campus (630 Perkins Extended), asking a date with wheels is strongly recommended. It's a long walk; it doesn't matter what a wonderful time you are or how much she (he) loves you. Auditions are all open, apprenticeship program allows students to get involved in other phases of the theatre. *Theatre Memphis* is open 8 Tu-Sun, Sun matinees at 2:30; reservations and info at 682-8323.

The *Little Theatre* of Theatre Memphis produces four shows of a less commercial, more aesthetic and controversial nature. It will begin July 15 with *In Fashion*. Season members of Theatre Memphis get \$1 discount at *Little Theatre*.

RESTAURANTS

Check out your billfold and restaurants, see "Eat."

Money Matters

CASHIER'S OFFICE

Cashier: Mrs. Sarah Bowlan
105 Palmer

Pay tuition, fees, fine, and parking tickets here. Mrs. Bowlan is willing to help with any accounts; if you're confused, go to her. All UPS packages

Money Matters

CASHIER'S OFFICE

Cashier: Mrs. Sarah Bowlan
105 Palmer

Pay tuition, fees, fine, and parking tickets here. Mrs. Bowlan is willing to help with any accounts; if you're confused, go to her. All UPS packages, special delivery and certified letters are delivered here. Stamps and scales for weighing parcels are available. Staff and student workers can also pick up office and printing supplies here. Lost and found items often turn up in this office. Students may cash checks up to \$15 per day, and may also set up a student deposit account (don't got it, don't spend it. ed.) *Very* nice people.

Hours: Monday thru Friday 8:30 a.m. - 3:30 p.m.

FINANCE OFFICE

This office handles all the official money matters of the college, including accounts of campus organizations.

Hours: Monday thru Friday 8:30 a.m.-noon; 1:00-5:00 p.m.

FINANCIAL AID

Director: Bill Jones
109 Palmer

The decisions of the Financial Aid Committee are based on the Parents' Confidential Statement form. Awards or adjustments can be appealed by submitting a request to the Committee through Mr. Jones. Students sit on this Committee along with faculty members. If you're on any financial aid, you'll receive the Statement forms to renew aid before we leave for Christmas.

Students who are working on campus through the Work-Study program receive their checks once per month (usually the 5th) from this office. Be sure you know whether you have Work-Study or Campus Employment because there is a difference.

This office works extremely hard for students by doing everything possible to obtain aid for everyone. Take your financial problems to them and get them to help you.

EXTRAS

First Tennessee Bank on Summer (open till 6 p.m. on Fridays) will cash SW student's checks with a SW I.D. Bristol's Fine Wines on Summer will cash checks at all hours.

Words of wisdom: long, scribbled notes on coke and candy machines mean they're swallowing money; go check another one. Cokemen are usually good about returning the loot, see Cashier's Office for money lost in Palmer machines and Student Center Office for Lair's machines.

RA's

See "Pictures" for names and faces of RAs (women); Asst. and Head RAs (men). An RA is someone who's around and someone to see if something comes up in the dorm. They make available simple medical remedies; communication to Maintenance, Dean of Students and Counseling Office; coordination of Commons; a shoulder to cry on; bull sessions. It'd be wise to know who and where your RAs are.

Registrar

From John Turpin's mouth: "Read pages 6, 38-39 and 47 of your 77-78 Catalog each morning before and after breakfast." A cooperative man who enjoys good conversation with students on his lunch hours near the amphitheatre; all you've heard about him is true (make your own judgement after you register).

Very important: Check "College Calendar" and SFA for time periods that you can add/drop or withdraw from classes.

Rumors

Let's face it--not much happens in the way of exciting news at Southwestern. Those things that *do* happen, everybody learns by rumor. The school *loves* rumors.

Security

Security officers are available--on call--to assist in emergencies and to escort students on campus after dark. RAs, not security officers, will open

Telephone: 274-0036

Security

Telephone: 274-0036

Security officers are available--on call--to assist in emergencies and to escort students on campus after dark. RAs, not security officers, will open dorm rooms if you're locked out (provided it's yours). Access to building after hours requires the professor's written permission on file and your personal appearance at the Security Shack.

Secure all valuable personal property in your room and lock it *at all times!* Do not loan your room key! Report unknown persons in dorms or anywhere on campus to Security immediately.

Social Life

A tremulous oracle of things to come during the year
(as read by an ex-senior)

Enjoy it! Everything will come with time if you are wise enough and patient enough. Some of what you learn is from the classrooms but more from the school. It is not the University of _____. There may not be something spectacular going on every week, although there probably is somewhere in Memphis. The goal of knowledge encompasses more than simply the end of the term when the grades get sent home. It entails the nights in the library (there will be many), the nights at the beer busts (there will be many), and the nights where you simply wander around and talk to people (there are many). As for the social life . . . well, there is one here. A good one if you are willing to go halfway and be a part of it instead of sitting back and expecting something that may not be there for you. Greek or independent, you can and will fit somewhere in the group as yourself. No one has ever said it was a passive place to be, just a touch more thoughtful, that's all.

In sum, social life at Southwestern comes easy if you relax and don't take it too seriously.

Student Center

- Top - Counseling Center, TV Room, Student Organization offices, rest rooms.
- Ground - Lair, Pub, Bookstore, East Lounge, Mailroom, drinking fountain, Student Center assistant's office, pay phone.
- Basement - Student Publications, rest rooms, pool and ping-pong tables, Language Lab, town student lockers, darkroom.

Student Organizations

BLACK STUDENT ASSOCIATION

President: Marva Davis

The Black Student Association (BSA) was organized in 1969 to promote and to coordinate the efforts of the black students of Southwestern. The organization's main objective is to educate *all* students on campus in black culture. BSA will kick off its year's activities with a dance in September and sponsor a Masquerade Party on October 31. The week of November 6-12 has been set aside as "Black Awareness Week" featuring speakers, choirs, and other forms of art relating to black culture and a formal dance. The BSA meets in the Black House next to the Security Shack.

CAMPUS ARTS COUNCIL

Music, the visual arts, literature, drama, and dance are integral parts of the philosophy of a liberal arts education. For this reason, the Campus Arts Council was formed in an effort to promote an interest in the Arts at Southwestern. The group is composed of all students interested in the arts (this includes science, business, economics, sociology, history, etc. majors) and is dedicated to making Art available to everyone. Programs in the first year ('76-'77) included a lecture on the Bayeux Tapestry by art history professor, Anne Robbins; a Baroque Concert with recorders, flutes, harpsichord and voices of the Music Department;

a tour of an exhibit of Oriental art from Southwestern's Clough Collection by Dr. George Apperson; and a concert of Renaissance music by the Madrigal Singers. Anyone interested in any facet of the Arts is encouraged to become involved with the group. (SFA will carry times of meetings and programs. ed.)

a tour of an exhibit of Oriental art from Southwestern's Clough Collection by Dr. George Apperson; and a concert of Renaissance music by the Madrigal Singers. Anyone interested in any facet of the Arts is encouraged to become involved with the group. (SFA will carry times of meetings and programs. ed.)

DILEMMA

Co-chairpersons: Mary Engels & Anne Herbers

For the past twelve years, Southwestern has presented *Dilemma* to the college and Memphis communities. Operated exclusively by Southwestern students and financed by private contributions, this symposium features an intellectually stimulating weekend of guest speakers and lecture seminars. *Dilemma '78* will involve "Ethical Decisions in a Changing Society" and will be held on March 3, 4, and 5. Ideas on the theme or names of speakers should be given to Anne, Mary or Edward Wheatley (Programs Chairman). Other committees are Publicity, Operations and Finance; help is always welcome and needed.

DRAMA - THE NEW SOUTHWESTERN PLAYERS

President: Preston Johnson
Vice President: Ken Ferguson

The New Southwestern Players is dedicated to the promotion and development of the performing arts on campus, including dance, avante-garde and classical drama, original plays and musical productions.

The three-day Renaissance Festival is held each year during Term III. Many classical productions are performed by students and faculty, most of them outdoors in the magnificent gothic setting. Other events include crafts displays, authentic music, and a joust. Other schools and theater organizations in the community also participate in the Festival.

HONOR COUNCIL

President: Bonnie Allen

The Honor System at Southwestern is an opportunity. Because the freedom and responsibility which the Honor Code allows us, we are able to strive personally for the fullest possible expression of individual harmony with community life.

FACES - is the campus directory; includes the address, phone number, and mug shot of each student, faculty and staff member. Most work is concentrated in the first weeks of school, and help is needed to match pictures with names.

Editors: Kathy Irwin & Sarah Minter

Ginger's purpose this year is not only to provide an outlet for campus creativity, but also to stimulate this creativity. As a publication that features poetry, prose, graphics and photography, *Ginger* welcomes all creative, original material. It will be put out twice this year and everyone is encouraged to contribute.

Editor: Cathy Roan

Handbook - you be the judge, you're holding it.

The '76-'77 *Lynx* broke away from the format of past years with short essays and senior photos. This year's *Lynx* will include some graphics, a few different camera angles. There's always room for people with cameras, ideas, layout ability (or willingness), essay talent, and a sense of humor. There will be an open forum meeting as soon as everybody is done unpacking. If you're interested, join up and express yourself. - the campus yearbook.

Editor: John Worden

The fact that Southwestern is small means that news travels fast, at least faster than *THE SOU'WESTER* can print it. The problem facing the paper is how to make the sorting-out-of-the-rumors more than just that. After all, not even lunch can make you read what you already know. The approach taken by Steve is one of openness and flexibility bordering on the careless. While many would be aghast at the daily operation, it has a tendency to produce a readable paper once in a while. News is, of course, central; but the paper attempts to reflect the campus community by printing original writings, interesting and "serious" photography, cartoons, and any garbage-in-words that becomes available. The result is a slightly uncommon newspaper, one that won one-third of awards last year in the state college paper competition.

Editor: Steve Minor

The Southwestern Journal provides an outlet for the best academic, and not-so-academic, papers written by students, faculty, and miscellaneous persons. This year *The Journal's* scope includes the best term papers as well as other types of writing (serious or humorous, short essays or long epistles, bitter diatribes or sugary propaganda.) An editorial board composed of students and faculty will re

The Southwestern Journal provides an outlet for the best academic, and not-so-academic, papers written by students, faculty, and miscellaneous persons. This year *The Journal's* scope includes the best term papers as well as other types of writing (serious or humorous, short essays or long epistles, bitter diatribes or sugary propaganda.) An editorial board composed of students and faculty will review and determine for publication all works submitted, solicited, squeezed, or otherwise secured from their authors. Hopefully, *The Journal* will be a needed stimulus to the lagging quality and quantity of student writing. So if you have ideas running around in your noggin just begging for expression, get out the ink and paper and express for *The Journal*: make it the sort of literary digest our campus needs. Need a small creative staff: several sets of ten fingers that can type, anybody who can layout copy, everybody with ideas, suggestions, and opinions and WRITERS! Interested? Then I want you.

Editor: Alice Smith

Student-Faculty-Administration Newsletter (SFA) - includes general announcements and the weekly calendar of events. To submit an announcement, fill out an announcement form in the Student Center lobby and leave it in the collection box.

Coeditors: Paul Renfroe & Ron Sims

Know who your editors are; see "Pictures."

THE SOUTHWESTERN FELLOWSHIP OF INTERVARSITY CHRISTIAN FELLOWSHIP

President: Steve Hatcher

The Southwestern Fellowship (S.F.) is made up of students dedicated to serving Christ in evangelism, discipleship, and missions while in college. Each week students meet in one of several small groups for Bible study and fellowship; every two weeks, for programs, speakers, and discussion.

The S.F. is a chapter of the nation-wide InterVarsity Christian Fellowship and participates in the retreats and camps at various times of the year, together with IVCF chapters at such schools as Tulane, Vanderbilt, and UT Knoxville.

SOCIAL REGULATIONS COUNCIL

President: Dan Cogswell

The name sounds a good bit more ominous than the actual Council. Social regulations of Southwestern are designed to keep rigid rules at a minimum and build responsibility within the individual living in the community. The basic function of the SRC is two fold. The first duty is to initiate social rules and regulations within the students and submit new rules and ideas to the Administration for approval. The second task is enforcement of standing regulations. Hopefully, the latter task is kept to a minimum by student use of common sense and thoughtful actions. The SRC also encourages communication between campus groups and also between students and the Administration: feedback is welcomed directly to SRC or through SGA reps.

Representatives:	Freshman: to be elected	Senior: Sara Bailey
	Sophomore: Kay Batey	Steve Masters
	Jeff Campbell	Secretary: Pam Wilson
	Junior: Carolyn Crenshaw	
	Cynthia Said	

STUDENT GOVERNMENT ASSOCIATION

President: Holton Guyton
 Vice President: Gary Minor
 Treasurer: Frances Clevenger
 Secretary: to be appointed

On May 19, 1977, students voted for a new constitution for the Student Government Association (SGA). The new SGA has 3 kinds of reps for a total of 18: 4 Class, 10 Dormitory, 4 At Large; plus four officers. The main purpose of these members is to promote an exchange of ideas among students; faculty, and administration. The SGA appoints students to serve on faculty and Board of Trustee committees, oversees the allocation of SGA funds (\$15,800), and involves itself in most facets of college life (whether students believe it or not!).

The seven Commissions have special areas of responsibility as the titles denote and are explained below. Commissioners report back to the assembly of reps at least once a month so that there is a smooth exchange of dialogue.

Getting involved in the SGA is not difficult, for it usually requires saying "yes" when asked to do something.

Elections will be held during the first three weeks in September.

Getting involved in the SGA is not difficult, for it usually requires saying "yes" when asked to do something.

Elections will be held during the first three weeks in September.

Athletic Commission

Concerned with the athletic interests of the student, it serves as a link between the student and the athletic department. Any or all questions concerning varsity, intramural and individual sports, facilities can often be answered through the Commission.

Board of Trustees

The Trustees hold the ultimate authority for Southwestern. Meeting three times a year, delegates from Presbyterian synods meet to discuss institutional advancement, faculty and student affairs, financial matters, and other business pertaining to the college. Three students who are selected by the SGA serve on each committee of the Board. Three students are elected from the student body to sit on the Board with voting privileges.

Elections Commission

Commissioner: Bart Spencer

This Commission handles the details of every student body election. Elections are announced two weeks in advance and petitions from the Commissioner are available at that time. Voting is by secret ballot; the Honor Code applies.

A tentative election schedule is listed below:

- September 20 - Board of Trustees and Commissioners
- September 21-27 - Dorm representatives
- September 27 - Publications Board representatives
- September 29 - Class secretaries
- October 4 - At Large representatives.

Publication Commission

Commissioner: Bill Nolan

The opportunities available to you in publications at Southwestern are nearly unlimited. The Publications Board is the governing body over all publications. It selects new editors each spring, allocates money and settles conflicts in editorial policy. To a large degree, editor selection and funding determine the nature of the publications, so the Pub Board wields a lot of power. Members of the Board include the seven editors, class representatives (to be elected) and the Commissioner who, experienced with college publications, is reviewed by the Board and elected by the student body.

Religion Commission

Separate from the Southwestern Fellowship (SF), the Commission will provide opportunities for broadening the horizons of your life in the light of the religions of the world. The Commission hosts seminars, retreats, services on special Sundays aimed at giving you a chance to get outside your own beliefs and explore new ideas.

Social Commission

Commissioners: Dena Brooks, Destry Held, Ron Sims,
Robbie Martin, Bruce Henderson, Mike McCadden

This is the first time that SW has such a large group for this function; the point is diversity. The Commission hopes to create better communication between the various art and talent groups on campus as well as bring in musical (jazz, classical, rock, country, etc.) and cultural (ballet, etc.) groups from elsewhere. Some traditional attractions include Homecoming Dance, feature-length movies (scheduled for Fridays, at last!), Common Houses. Ideas welcomed.

Welfare Commission

The Student Catch-All and Referral Agency. In addition, anything concerning the improvement and furtherance of the educational experience--discussions, talks, curriculum, and student welfare is the function of this Commission.

WUB Commission

WUB highlights women in the SW community as well as women in general. WUB attempts to provide various entertaining social events (ice cream socials, etc.) and provocative educational experiences (seminars, self-help clinics, Women's

WUB Commission

WUB highlights women in the SW community as well as women in general. WUB attempts to provide various entertaining social events (ice cream socials, etc.) and provocative educational experiences (seminars, self-help clinics, Women's Weekend, a library featuring female authors in Counseling Center.)

Wheels

CAMPUS

Southwestern has four vehicles for use by faculty, administrators, and students when engaged in college business. To reserve a car, fill out a Vehicle Request form, have it approved by the appropriate department chairman, and return it to the Maintenance Office during business hours. Reservations are first come, first serve. Keys are picked up from and returned to the Security Office, only with the properly authorized form.

PERSONAL

Student cars and bicycles should be registered with Security during the first week for parking privileges. Library lane and the lot west of the Student Center are reserved areas, and fines start at \$4.

Generous friends will lend cars and rides. Don't forget the wheels attached to your "bod."

PUBLIC

MEMPHIS TRANSIT AUTHORITY

523-2521
fare: 50¢

- #53 Faxon-Summer: towards downtown, every 30 minutes, stop at University and North Parkway.
- #52 Jackson-Raleigh: towards Raleigh Springs Mall, every 30 minutes, stop at Jackson and University.
- #3 Summer-Macon: towards downtown, every 30 minutes, stop at Broad Street and East Parkway.

GREYHOUND BUS LINES
203 Union Avenue*

523-7676

CONTINENTAL TRAILWAYS
235 Union Avenue*

523-0200

*This is downtown, go with a couple of friends.

WLYX

On the FM dial: WLYX at 89.3 with a power of 2.75 kilowatts (Tel. 272-1232) and WSWM at 91.7 with a power of 100 watts (Tel. 276-3812) are license to South-western. WLYX has developed a following in the community and is noted for its jazz and "progressive rock" program. SW Radio Readers (Tel. 276-1711) reads magazines and newspapers over closed circuit radio system to the blind and physically handicapped. The broadcasting studios are in the fourth tower of the gym.

Who & Where for Whatever

Alcoholic beverages...beer busts	Graffiti.....Library carrols
Policy.....Catalogue	<i>Sou'wester</i> Office
Abuse.....SRC; Dan Cogswell	Human Relation Area
Permission to serve at	Files.....Anthro/Soc office
social functions.....SRC	Room changes.....RAs
Audio-visual aids	ROTC (Air Force).....Prof. J. Russell
Records.....Circulation Desk,	Transcripts.....Registrar's Office
Library	Tutoring Service.....your professor
Tapes.....Language Lab	Counseling Office
Projectors..Ace Emery, Physics	Tutorials.....your professor or
Draft registration info..Registrar	dept chairman
Dress code.....what's clean?	Zoo U.....across the street
Drug abuse info.....Counseling Office	from Overton Park
Grad. School catalogs.Counseling Office	Zoo

Afterword & Staff Credit

We have solicited material published here from representatives of organizations where possible; talks with staff, faculty and students; and from a questionnaire given Term III last year.

Other sources that you can consult include Catalogue, upperclassmen, and students of opposite sex (the info may not be too reliable, but it will likely be more entertaining).

We'd like to thank all those who contributed material and assistance to this handbook. Special thanks go to Annie Stein whose Handbook '76 was the basis for this year's edition, Steve Collins for his enthusiasm and encouragement, Antonia Waugh for her artistic touch, Helen Adamo for her typewriter, and Martha Jane Edwards for her "professional advice."

Lastly, Mary and Li Li pat each other on the back.



